

BUILDING APPRAISAL

The building appraised at \$36,730,824 and the contents at \$6,755,670 for a cost of reproduction new. Our current policy insures the building for \$30,240,000 and the contents for \$8,701,981. Our broker is working with Hanover to get a quote for increased coverage for the building and decreased coverage for the contents.

**Total Cost of Reproduction New for Building & Contents: \$43,486,494**

**Current Coverage of Building & Contents: \$38,941,980**

**Elmhurst Public Library  
Elmhurst, Illinois**

# **Appraisal**

**Insurance Values**

Valuation Date: March 12, 2024

IAC Reference Number: E5-1079

IAC Revaluation Number: 2156525



**Industrial Appraisal**  
— COMPANY —

Two Gateway Center  
603 Stanwix Street, Suite 1450  
Pittsburgh, Pennsylvania 15222  
800-245-2718 / 412-471-1758 FAX  
[www.indappr.com](http://www.indappr.com)



April 18, 2024

Elmhurst Public Library  
Elmhurst, Illinois

The Industrial Appraisal Company is pleased to submit the results of its appraisal and report of the buildings, fixed contents, movable contents, and property in the open of Elmhurst Public Library, located in Elmhurst, Illinois.

This report is based on an on-site inspection and analysis by Industrial Appraisal Company personnel in accordance with a formal agreement authorizing the appraisal. The effective date of this appraisal is deemed to be March 12, 2024.

The purpose of this study is to establish an independent, professional opinion of the insurable value of the property appraised and to provide proof of loss documentation should the need arise.

This report includes a summarized description of the buildings as well as the inventory of equipment assets in various classifications by location/area.

The appraisal does not include land, landscaping, consumable supplies, valuable papers, licensed vehicles, intangible assets, or property of third parties.

It must be noted that should a partial loss occur, the amount of the loss may be estimated based on the repair costs which are proportionately higher than the cost of reproduction new as defined and estimated.

The valuation determinations reflected in this report are defined as follows:

**Cost of Reproduction New** is the "cost of reproducing a new replica of a property on the basis of current prices with the same or closely similar materials allowing for contractor's overhead, profit, and architectural fees, but without provision for overtime, bonuses and premiums of any kind". The Replacement Insurable Value reflects the adjustment of "Exclusions" comprised of the following items: excavation and filling; portions of foundations which are below the under-surface of the lowest floor or are below the surface of the ground; and underground sewage, piping and wiring.

**Sound Value** – Value based upon the cost of reproduction new less an allowance for accrued depreciation resulting from age and condition. Sound Value is often referred to as Actual Cash Value within the insurance industry.



The valuation methodology utilized in this report for building assets involved the segregated cost method in the calculation of the Cost of Reproduction New, and in some instances the cost calculator and component part pricing methods, based upon proprietary indices available to and developed by the Industrial Appraisal Company. In estimating these replacement valuations, additional costs which could be associated with conforming to local building codes, municipal ordinances, federal standards, historical relevance, or other legal restrictions were not considered, nor was any value assigned to the cost of demolition or the removal of destroyed property should a loss occur.

The valuation methodology utilized in this report for major items of permanent fixtures, machinery, furniture and equipment was developed based on verifications of costs, documentation or quotations available from suppliers and manufacturers, and/or via consultation with appropriate staff at the site. The appraised valuations assume the cost of freight and installation. In many instances, replacement value has been determined for generic items "at average" for the property type based on the appraiser's assessment of observed quality. The classification of Owner's List and Value appears in the report for Books and Periodicals, AV Software or Equipment, and Miscellaneous Equipment. These items were not inspected by the appraiser, however, were entered into the report based on collaboration and/or information supplied to the appraiser. Minor items have been valued by group classification based on the agreed upon cutoff threshold as applicable.

The building account classification comprises (as applicable) general construction, plumbing, sewage, heating, ventilating, air conditioning, electrical lighting, sprinkler and fire alarm systems, and selected building fixtures.

The summary of values report also lists several different data elements of each building structure. Most of these are self-explanatory such as construction year, square footage, stores and occupancy. The construction class information is based on the ISO (Insurance Service Office) code, these are identified as follows:

Class 1	Frame Construction
Class 2	Joisted Masonry
Class 3	Non Combustible
Class 4	Masonry Non Combustible
Class 5	Modified Fire Resistant
Class 6	Fire Resistant

The fire alarm designations in your report are defined as follows:

None	No fire alarm exists
Local	Alarm sound in captioned building only
Central	Alarm sounds in captioned building and at remote designated location also (fire station, residence, etc.)



This report is comprised of the following sections:

- This Introductory Explanation and **Certificate** which summarizes the appraisal procedure and valuation methodology;
- A valuation **Summary** reflecting the insurable values by building/location.
- A **Building Index** and **Asset classification Coding Index**.
- **Detail** section by building of movable contents by room or area.
- **Single Page Summary** for each building which includes a building photograph, plat, appraised values, and general pertinent building information.

Based upon the foregoing investigation, analysis and methodology employed, it is our opinion that the aggregate values for all assets under appraisal are as follows:

<b>COST OF REPRODUCTION NEW</b>	-	<b>\$43,690,109</b>
<b>SOUND VALUE</b>	-	<b>\$34,732,968</b>

In interpreting the Summary of Values report, the figures shown in Column 3 of the Summary report reflect the Cost of Reproduction New less exclusions. If the property coverage is based upon Sound Value (Actual Cash Value), the values shown in Column 6 represent the depreciated value less exclusions. Exclusions comprise such items as excavation and filling, below surface foundations, underground piping and wiring, and are generally considered as non-insurable.

Industrial Appraisal Company anticipates updating the report of insurable values on an annual basis to include property changes that can be reported, or if warranted and authorized, to include new site inspections on a selected basis. Updating procedures and reporting requirements will be coordinated through separate communications.

In the event of a loss covered by insurance, provided immediate written notice is given to the Corporate Office and our Annual Revaluation Service is in effect, the Industrial Appraisal Company will provide updated values for the properties appraised to assist in the preparation of Proof of Loss. Documentation support will be limited to the existing file.

All significant work papers and documents relating to this assignment will be held for five years beyond the last updating of valuations.

This appraisal is provided solely for the benefit of the purchaser of service and is not to be used for purposes other than as disclosed in advance of this engagement.



Our estimates of value should be viewed as independently established, reasonable, true and correct to the best of our knowledge. We have inspected all of the property that is the subject of this report except where otherwise stated.

In formulating our conclusions, we may rely on information provided by the client or others. Should new information become available after a draft or final report has been submitted, we reserve the right to amend or modify our report and the conclusions therein.

If there are inquiries concerning the inclusion or exclusion of items not covered by this study, or the valuations set forth in the report, such inquiries must be transmitted in writing to the Industrial Appraisal Company no later than 60 days after receipt of this analysis. If no written inquiries are transmitted within the stipulated period, the complete report and valuations set forth therein shall be deemed to have been accepted.

We appreciate the opportunity to be of service in these valuation requirements.

Respectfully submitted,

INDUSTRIAL APPRAISAL COMPANY

Site Appraiser: Shaun M. Lasich

\*If you have any questions concerning this appraisal, contact Mr. Antonio Esposito at 1-800-245-2718, Ext. 1754, or [aesposito@indappr.com](mailto:aesposito@indappr.com)



# Industrial Appraisal Company

Elmhurst Public Library

## Insurance Summary

Valuation Date: 3/12/2024

BUILDING OR UNIT	Appraisal Date	COST OF REPRODUCTION NEW			SOUND VALUE		
		TOTAL	EXCLUSIONS	INCLUSIONS	TOTAL	EXCLUSIONS	INCLUSIONS
BLDG NO: 0101							
LIBRARY							
125 S PROSPECT AVE							
ELMHURST, IL 60126							
OCCUPANCY: LIBRARY							
CONST YEARS: 2003							
CONSTRUCTION CLASS: 5							
SUPER SQFT: 80,067 / BASEMENT SQFT: 8,993							
STORIES: 2							
CONDITION: GOOD							
BUILDING	03/24	\$32,664,740	\$1,188,350	\$31,476,390	\$25,446,310	\$938,800	\$24,507,510
ARCHITECT FEES	03/24	\$2,286,524		\$2,286,524	\$1,781,231		\$1,781,231
DETAILED PERMANENT FIXTURES	03/24	\$1,779,560		\$1,779,560	\$1,373,244		\$1,373,244
TOTAL BUILDING		\$36,730,824	\$1,188,350	\$35,542,474	\$28,600,785	\$938,800	\$27,661,985
OFFICE FURNITURE	03/24	\$624,270		\$624,270	\$453,097		\$453,097
HOUSEHOLD FURNISHING/PERSONAL PROPERTY	03/24	\$236,745		\$236,745	\$143,983		\$143,983
OFFICE MACHINES & DEVICES	03/24	\$201,195		\$201,195	\$123,905		\$123,905
AUDIO VISUAL EQUIPMENT	03/24	\$180,690		\$180,690	\$114,364		\$114,364
EDP EQUIPMENT	03/24	\$880,520		\$880,520	\$580,485		\$580,485
TELEPHONE SYSTEM	03/24	\$108,000		\$108,000	\$64,800		\$64,800
MEDICAL/HOSPITAL EQUIPMENT	03/24	\$3,000		\$3,000	\$1,950		\$1,950
FOOD SERVICE & APPLIANCES	03/24	\$52,390		\$52,390	\$34,585		\$34,585
MUSIC EQUIPMENT & INSTRUMENTS	03/24	\$1,500		\$1,500	\$900		\$900
GROUND/GREENS EQUIPMENT	03/24	\$36,995		\$36,995	\$22,197		\$22,197
MAINTENANCE EQUIPMENT	03/24	\$6,350		\$6,350	\$4,010		\$4,010



Valuation Date: 3/12/2024

BUILDING OR UNIT	Appraisal Date	COST OF REPRODUCTION NEW			SOUND VALUE		
		TOTAL	EXCLUSIONS	INCLUSIONS	TOTAL	EXCLUSIONS	INCLUSIONS
BOOKS & PERIODICALS 'OV'	03/24	\$3,262,420		\$3,262,420	\$3,262,420		\$3,262,420
AV SOFTWARE OR EQUIPMENT 'OV'	03/24	\$1,025,000		\$1,025,000	\$1,025,000		\$1,025,000
MISCELLANEOUS EQUIPMENT 'OV'	03/24	\$136,595		\$136,595	\$136,595		\$136,595
TOTAL CONTENTS		\$6,755,670		\$6,755,670	\$5,968,291		\$5,968,291
TOTAL BUILDING & CONTENTS		\$43,486,494	\$1,188,350	\$42,298,144	\$34,569,076	\$938,800	\$33,630,276





# Industrial Appraisal Company

Elmhurst Public Library

## Insurance Summary

Valuation Date: 3/12/2024

BUILDING OR UNIT	Appraisal Date	COST OF REPRODUCTION NEW		SOUND VALUE	
		TOTAL	EXCLUSIONS	INCLUSIONS	INCLUSIONS
BLDG NO: 0199					
LIBRARY PITO					
125 S PROSPECT AVE					
ELMHURST, IL 60126					
OCCUPANCY: PROPERTY IN THE OPEN					
INSURABLE SITE IMPROVEMENTS	03/24	\$162,685		\$162,685	\$130,148
STATUES/MEMORIALS/MONUMENTS	03/24	\$10,000		\$10,000	\$9,000
DETAILED PERMANENT FIXTURES	03/24	\$30,930		\$30,930	\$24,744
TOTAL BUILDING		\$203,615	\$0	\$203,615	\$163,892
TOTAL CONTENTS		\$0		\$0	\$0
TOTAL BUILDING & CONTENTS		\$203,615	\$0	\$203,615	\$163,892



# Industrial Appraisal Company

Elmhurst Public Library

## Insurance Summary

Valuation Date: 3/12/2024

BUILDING OR UNIT	Appraisal Date	COST OF REPRODUCTION NEW			SOUND VALUE		
		TOTAL	EXCLUSIONS	INCLUSIONS	TOTAL	EXCLUSIONS	INCLUSIONS
BUILDING TOTAL		\$34,647,915	\$1,188,350	\$33,459,565	\$26,983,446	\$938,800	\$26,044,646
ARCHITECT FEES		\$2,286,524		\$2,286,524	\$1,781,231		\$1,781,231
GRAND TOTAL BUILDING		\$36,934,439	\$1,188,350	\$35,746,089	\$28,764,677	\$938,800	\$27,825,877
CONTENTS TOTAL		\$2,331,655		\$2,331,655	\$1,544,276		\$1,544,276
CONTENTS X TOTAL		\$4,424,015		\$4,424,015	\$4,424,015		\$4,424,015
GRAND TOTAL CONTENTS		\$6,755,670		\$6,755,670	\$5,968,291		\$5,968,291
GRAND TOTAL		\$43,690,109	\$1,188,350	\$42,501,759	\$34,732,968	\$938,800	\$33,794,168

GRAND TOTAL APPRAISED

SQ. FOOTAGE: 89,060

(SUPERSTRUCTURE: 80,067 / BASEMENT: 8,993)



<b>BLDG NO</b>	<b>BUILDING NAME</b>	<b>ADDRESS</b>
0101	Library	125 S Prospect Ave, Elmhurst, IL 60126
0199	Library PITO	125 S Prospect Ave, Elmhurst, IL 60126



<b>Class Code</b>	<b>Asset Class</b>
002	INSURABLE SITE IMPROVEMENTS
010	STATUES/MEMORIALS/MONUMENTS
021	DETAILED PERMANENT FIXTURES
042	OFFICE FURNITURE
043	HOUSEHOLD FURNISHING/PERSONAL PROPERTY
044	OFFICE MACHINES & DEVICES
045	AUDIO VISUAL EQUIPMENT
046	EDP EQUIPMENT
047	TELEPHONE SYSTEM
049	MEDICAL/HOSPITAL EQUIPMENT
051	FOOD SERVICE & APPLIANCES
057	MUSIC EQUIPMENT & INSTRUMENTS
065	GROUPS/GREENS EQUIPMENT
072	MAINTENANCE EQUIPMENT
080	BOOKS & PERIODICALS 'OV'
085	AV SOFTWARE OR EQUIPMENT 'OV'
086	MISCELLANEOUS EQUIPMENT 'OV'



# Industrial Appraisal Company

Elmhurst Public Library

## Contents

Valuation Date: 3/12/2024

BLDG	FLOOR	CLASS	ITEM ID NO	QTY	LIBRARY	DESCRIPTION	CRN	SOUND
0101					<u>LIBRARY</u>			
0101	B				<u>THE MAKERY</u>			
0101	B	042		14		STAINED AND VARNISHED TABLES, ON METAL LEG AND STRETCHER BASE, 72" X 36" X 30"	\$13,930	\$11,144
0101	B	042		1		LOT OF MISCELLANEOUS MINOR EQUIPMENT	\$26,010	\$16,907
0101	B	044		1		RICOH IMC3000LT COPIER, WITH TBS PAY STATION	\$15,000	\$10,500
0101	B	044		1		ELLISON DIE PRESS SYSTEM, CONSISTING OF	\$22,395	\$13,437
0101	B	044			1 - PRESS			
0101	B	044			176 - DIES, 5"			
0101	B	044			4 - DIES, 11"			
0101	B	044			19 - DIES, 13"			
0101	B	044		1		EPILOG FUSION EDGE LASER ENGRAVER, WITH AIR FILTRATION SYSTEM	\$13,000	\$9,100
0101	B	044		1		GBC ULTIMA 65 LAMINATOR	\$3,320	\$2,158
0101	B	044		1		HEAT PRESS NATION FLAT SILKSCREEN PRESS, MODEL HPN-SIG-1624-A	\$1,000	\$700
0101	B	044		1		HEAT PRESS NATION FLAT SILKSCREEN PRESS, MODEL HPN-SIG-1515-S-V2	\$600	\$420
0101	B	044		1		HEAT PRESS NATION CERAMIC CYLINDRICAL PRESS, MODEL HPN-SIG-MUG	\$620	\$434
0101	B	044		1		LOT OF MISCELLANEOUS MINOR EQUIPMENT	\$12,450	\$7,470
0101	B	046		2		DELL LAPTOP COMPUTERS, WITH MONITOR, KEYBOARD AND MOUSE	\$2,000	\$1,400
0101	B	046		1		LENOVO WORKSTATION, WITH MONITOR, KEYBOARD, MOUSE, BARCODE READER AND RECEIPT PRINTER	\$1,650	\$1,155
0101	B	046		1		LENOVO WORKSTATION, WITH MONITOR, KEYBOARD, MOUSE AND SCANNER	\$1,350	\$945
0101	B	046		1		SAWGRASS SG1000 WORKSTATION, WITH MONITOR, KEYBOARD, MOUSE AND PRINTER	\$2,650	\$1,855
0101	B	046		1		INFOCUS INTERACTIVE BOARD, 6' X 4', WALL MOUNTED	\$2,330	\$1,631
0101	B	046		1		MAKERBOT 3D PRINTER	\$2,100	\$1,470
0101	B	046		2		DREMEL 3D PRINTERS	\$4,000	\$2,800
0101	B	046		1		CANON IMAGEPROGRAF PRO 4100S PRINTER	\$5,650	\$3,955



BLDG	FLOOR	CLASS	ITEM ID NO	QTY	DESCRIPTION	CRN	SOUND
0101	B				<u>MECHANICAL ROOMS</u>		
0101	B	042		1	LOT OF MISCELLANEOUS MINOR EQUIPMENT	\$950	\$570
0101	B	046		1	LENOVO WORKSTATION, WITH MONITOR, KEYBOARD AND MOUSE	\$1,050	\$630
0101	B	072		1	LOT OF MISCELLANEOUS MINOR EQUIPMENT	\$4,000	\$2,600
0101	T				<u>THROUGHOUT</u>		
0101	T	021		1	LOT OF 5785 SQUARE YARDS OF WALL TO WALL CARPETING, ON BACKING	\$260,225	\$189,146
0101	T	021		1	LOT OF WINDOW TREATMENTS	\$62,500	\$40,625
0101	T	045		1	SECURITY CAMERA SYSTEM, WITH 67 CAMERAS	\$100,500	\$60,300
0101	T	046		1	NETWORK SYSTEM, CONSISTING OF SERVERS, SWITCHES, FIREWALL, ROUTERS, WIRELESS ACCESS POINTS, CABLES, CONNECTORS, RACKS, ETC.	\$155,000	\$93,000
0101	T	046		28	DELL LAPTOP COMPUTERS	\$28,000	\$16,800
0101	T	046		1	LOT OF MISCELLANEOUS MINOR EQUIPMENT	\$3,000	\$1,800
0101	T	047		1	MITEL TELEPHONE SYSTEM, WITH 72 HANDSETS	\$108,000	\$64,800
0101	T	080		1	LOT OF LIBRARY VOLUMES, ADULT AND CHILDRENS FICTION AND NONFICTION, REFERENCE AND PERIODICALS	\$3,262,420	\$3,262,420
0101	T	085		1	LOT OF AUDIO-VISUAL MEDIA	\$1,025,000	\$1,025,000
0101	T	086		1	LIBRARY OF EXTRAORDINARY THINGS	\$136,595	\$136,595
0101	1				<u>MEETING ROOM #2A/2B</u>		
0101	1	042		1	STAINED AND VARNISHED COOKING INSTRUCTION CABINET, 8' X 3' X 2 1/2', CASTER BASE, WITH TOP MIRROR AND ELECTRIC RANGE	\$6,500	\$5,200
0101	1	042		1	STAINED AND VARNISHED WOOD PORTABLE PUPPET THEATER, 8' X 7' X 2', WITH CURTAIN	\$2,650	\$2,120
0101	1	042		1	LOT OF MISCELLANEOUS MINOR EQUIPMENT	\$17,790	\$13,343
0101	1	045		1	SOUND AND VIDEO SYSTEM, CONSISTING OF	\$35,000	\$24,500
0101	1	045		2	MOTORIZED PROJECTION SCREENS, 10' X 8'		
0101	1	045		2	LCD PROJECTORS		
0101	1	045		1	DELL INTERACTIVE BOARD		
0101	1	045		1	CRESTRON CONTROLLER		
0101	1	045		1	CROWN AMPLIFIER		
0101	1	045			WITH CABLES, CONNECTORS, SPEAKERS, WIRELESS MICROPHONE KITS, ETC.		



BLDG	FLOOR	CLASS	ITEM ID NO	QTY	DESCRIPTION	CRN	SOUND
0101	1				<u>KITCHEN</u>		
0101	1	021		1	WOOD LAMINATE WALL TABLE, 12 LINEAL FEET X 2'	\$1,200	\$1,020
0101	1	021		1	STAINLESS STEEL 3 BOWL SCULLERY SINK, 6 LINEAL FEET, WITH SIDEBOARDS, WITH 2 TIER OVERSHELF	\$2,495	\$2,121
0101	1	021		1	STAINLESS STEEL HAND SINK	\$395	\$336
0101	1	051		1	TRUE STAINLESS STEEL 1 DOOR REFRIGERATOR, 27", CASTER BASE	\$10,090	\$7,063
0101	1	051		1	TRUE STAINLESS STEEL 1 DOOR UNDERCOUNTER REFRIGERATOR, 27"	\$3,195	\$2,237
0101	1	051		1	TRUE STAINLESS STEEL 1 DOOR UNDERCOUNTER FREEZER, 27"	\$4,165	\$2,916
0101	1	051		1	LOT OF MISCELLANEOUS MINOR EQUIPMENT	\$850	\$595
0101	1				<u>KOSSMANN ROOM</u>		
0101	1	042		1	LOT OF MISCELLANEOUS MINOR EQUIPMENT	\$12,065	\$7,842
0101	1	045		1	SOUND AND VIDEO SYSTEM, CONSISTING OF	\$24,500	\$17,150
0101	1	045		1	1 - MOTORIZED PROJECTION SCREEN, 10' X 8'		
0101	1	045		1	1 - LCD PROJECTOR		
0101	1	045		1	1 - SHARP INTERACTIVE BOARD		
0101	1	045		1	1 - CROWN AMPLIFIER		
0101	1	045		1	1 - CRESTRON CONTROLLER		
0101	1	045			WITH CABLES, CONNECTORS, SPEAKERS, WIRELESS MICROPHONE KITS, ETC.		
0101	1				<u>LOBBY</u>		
0101	1	021		1	FROSTED GLASS DEDICATION PLAQUE, 12' X 8'	\$24,000	\$19,200
0101	1	021		2	STAINED AND VARNISHED DISPLAY CASES, 5' X 5' X 2', 2 GLASS DOORS, INTEGRAL LIT	\$6,250	\$5,000
0101	1	021		2	COMMUNITY BOARDS, WITH 2 GLASS DOORS, 5' X 5'	\$2,400	\$1,920
0101	1	021		2	PAINTED STEEL LIBRARY SHELF UNITS, 6 LINEAL FEET X 7' X 1', WITH STAINED AND VARNISHED ENDS, MODERN DESIGN	\$3,450	\$2,760
0101	1	042		2	STAINED AND VARNISHED BENCHES, LEG BASE, 72" X 24" X 18"	\$2,000	\$1,200
0101	1	042		1	LOT OF CARPET RUNNERS	\$3,000	\$1,800
0101	1	042		1	LOT OF MISCELLANEOUS MINOR EQUIPMENT	\$1,000	\$600
0101	1	045		1	SHARP TV, 60", ON CART	\$895	\$537
0101	1	046		1	TOUCH SCREEN DIRECTORY, IN METAL KIOSK, FLOOR STANDING TYPE, 34" X 78" X 8"	\$10,000	\$6,000



# Industrial Appraisal Company

Elmhurst Public Library

## Contents

Valuation Date: 3/12/2024

BLDG	FLOOR	CLASS	ITEM ID NO	QTY	DESCRIPTION	CRN	SOUND
0101	1				<b>CAFETERIA</b>		
0101	1	021		1	STAINED AND VARNISHED CURVED SERVING CABINET, WITH STONE TOP, 28 LINEAL FEET	\$28,000	\$22,400
0101	1	021		1	STAINLESS STEEL 3 BOWL SCULLERY SINK, 6 LINEAL FEET	\$2,195	\$1,756
0101	1	021		1	STAINLESS STEEL HAND SINK	\$395	\$316
0101	1	042		1	LOT OF MISCELLANEOUS MINOR EQUIPMENT	\$5,585	\$3,909
0101	1	043		6	STAINED AND VARNISHED OPEN ARM LOUNGE CHAIRS, NAUGAHYDE UPHOLSTERED, WITH LEG BASE	\$17,970	\$12,579
0101	1	051		1	MANITOWOC ICE MACHINE, MODEL QY0214A	\$3,995	\$2,397
0101	1	051		1	TRUE STAINLESS STEEL 1 DOOR UNDERCOUNTER REFRIGERATOR, 27"	\$3,195	\$2,237
0101	1	051		1	TRUE STAINLESS STEEL 2 DOOR UNDERCOUNTER REFRIGERATOR, 36"	\$3,995	\$2,797
0101	1	051		1	ENAMELED METAL AND GLASS DISPLAY REFRIGERATOR, WITH TOP PASTRY CABINET, 3 TIERS, MODEL THAC-36-DG-LD	\$5,995	\$4,197
0101	1				<b>CIRCULATION AREA</b>		
0101	1	021		1	STAINED AND VARNISHED CURVED CIRCULATION DESK, WITH WOOD LAMINATE TOP, 56 LINEAL FEET	\$56,000	\$44,800
0101	1	021		1	STAINED AND VARNISHED BOOKCASE, 30 LINEAL FEET X 7' X 1'	\$14,175	\$11,340
0101	1	021		3	STAINED AND VARNISHED BOOKCASES, 3 SIDED, 10 LINEAL FEET X 7' X 1', WITH REAR PANEL, 4' X 7'	\$50,250	\$40,200
0101	1	021		1	STAINED AND VARNISHED BOOKCASE, 2 SIDED, 10 LINEAL FEET X 7' X 1', WITH REAR PANEL, WITH PERSONAL COMPUTER CARREL, 3' X 3'	\$18,250	\$14,600
0101	1	021		1	STAINED AND VARNISHED BOOKCASE, 4 SIDED, 12 LINEAL FEET X 7' X 1'	\$17,100	\$13,680
0101	1	021		1	PAINTED STEEL LIBRARY SHELF UNIT, 12 LINEAL FEET X 7' X 1'	\$2,550	\$2,040
0101	1	021		1	STAINED AND VARNISHED WALL TABLE, WITH STONE TOP, 14 LINEAL FEET X 2', 4 PEDESTALS	\$2,200	\$1,760
0101	1	042		3	METAL ROTARY MAGAZINE CAROUSELS, 4 SIDED, 4 TIERS, CASTER BASE	\$3,585	\$2,510
0101	1	042		1	LOT OF MISCELLANEOUS MINOR EQUIPMENT	\$3,360	\$2,352
0101	1	046		1	LENOVO WORKSTATION, WITH MONITOR, KEYBOARD AND MOUSE	\$1,050	\$630
0101	1	046		3	LENOVO WORKSTATIONS, WITH MONITOR, KEYBOARD, MOUSE, BARCODE READER, RECEIPT PRINTER AND RFID PAD	\$12,450	\$7,470
0101	1	046		1	LENOVO WORKSTATION, WITH MONITOR, KEYBOARD, MOUSE AND HP LASERJET PRO M402DN PRINTER	\$4,450	\$2,670
0101	1	046		3	BIBLIOTHECA SELF-CHECKOUT SYSTEMS, COUNTER TOP TYPE	\$49,500	\$29,700
0101	1	046		1	SQUARE POINT OF SALE SYSTEM, WITH CASH DRAWER, RECEIPT PRINTER AND CREDIT CARD/SIGNATURE PAD	\$1,000	\$600
0101	1	049		1	DEFIBTECH AED	\$1,500	\$1,050





# Industrial Appraisal Company

Elmhurst Public Library

## Contents

Valuation Date: 3/12/2024

BLDG	FLOOR	CLASS	ITEM ID NO	QTY	DESCRIPTION	CRN	SOUND
0101	1				<b>CHILDRENS LIBRARY</b>		
0101	1	021		1	PAINTED STEEL LIBRARY SHELF UNIT, 24 LINEAL FEET X 5 1/2' X 1'	\$5,100	\$4,080
0101	1	021		1	PAINTED STEEL LIBRARY SHELF UNIT, 8 LINEAL FEET X 7' X 1'	\$1,700	\$1,360
0101	1	021		1	STAINED AND VARNISHED BOOKCASE, 18 LINEAL FEET X 4 1/2' X 1'	\$5,400	\$4,320
0101	1	021		7	PAINTED STEEL LIBRARY SHELF UNITS, 30 LINEAL FEET X 5 1/2' X 2', WITH STAINED AND VARNISHED SLAT FACED ENDS	\$62,475	\$49,980
0101	1	021		2	PAINTED STEEL LIBRARY SHELF UNITS, 27 LINEAL FEET X 5 1/2' X 2', WITH STAINED AND VARNISHED SLAT FACED ENDS	\$16,200	\$12,960
0101	1	021		2	PAINTED STEEL LIBRARY SHELF UNITS, 15 LINEAL FEET X 5 1/2' X 2', WITH STAINED AND VARNISHED SLAT FACED ENDS	\$9,600	\$7,680
0101	1	021		2	PAINTED STEEL LIBRARY SHELF UNITS, 12 LINEAL FEET X 5 1/2' X 2', WITH STAINED AND VARNISHED SLAT FACED ENDS	\$7,950	\$6,360
0101	1	021		1	PAINTED STEEL LIBRARY SHELF UNIT, 21 LINEAL FEET X 5 1/2' X 2', WITH STAINED AND VARNISHED SLAT FACED ENDS	\$6,450	\$5,160
0101	1	021		1	PAINTED STEEL LIBRARY SHELF UNIT, 15 LINEAL FEET X 4 1/2' X 2', WITH STAINED AND VARNISHED SLAT FACED ENDS	\$5,250	\$4,200
0101	1	021		1	PAINTED STEEL LIBRARY DISPLAY SHELF UNIT, 3 TIERS, 24 LINEAL FEET X 4 1/2' X 1 1/2', WITH STAINED AND VARNISHED END	\$6,000	\$4,800
0101	1	021		1	PAINTED STEEL LIBRARY SHELF UNIT, 27 LINEAL FEET X 4 1/2' X 3', WITH STAINED AND VARNISHED ENDS	\$9,785	\$7,828
0101	1	021		1	PAINTED STEEL LIBRARY SHELF UNIT, 30 LINEAL FEET X 4 1/2' X 3', WITH STAINED AND VARNISHED ENDS	\$10,800	\$8,640
0101	1	021		1	PAINTED STEEL LIBRARY DISPLAY SHELF UNIT, 3 TIERS, 18 LINEAL FEET X 4 1/2' X 3'	\$6,090	\$4,872
0101	1	021		1	PAINTED STEEL LIBRARY SHELF UNIT, 12 LINEAL FEET X 4 1/2' X 3', WITH STAINED AND VARNISHED ENDS	\$40,710	\$32,568
0101	1	021		1	PAINTED STEEL LIBRARY SHELF UNIT, 9 LINEAL FEET X 3 1/2' X 2', WITH STAINED AND VARNISHED ENDS	\$2,195	\$1,756
0101	1	021		1	PAINTED STEEL LIBRARY SHELF UNIT, 12 LINEAL FEET X 3 1/2' X 2', WITH STAINED AND VARNISHED ENDS	\$2,700	\$2,160
0101	1	021		1	WOOD LAMINATE CURVED LIBRARIANS DESK, STONE TOP, 35 LINEAL FEET	\$35,000	\$28,000
0101	1	021		1	STAINED AND VARNISHED DISPLAY CABINET, 16 LINEAL FEET X 4' X 2', INTEGRAL LIT	\$9,600	\$7,680
0101	1	021		1	AQUARIUM, 4' X 3' X 1', WITH FILTERS, AERATORS, ETC.	\$5,000	\$3,000
0101	1	021		1	LOT OF EARLY LITERARY FIXTURES	\$100,000	\$80,000
0101	1	042		1	WOOD LAMINATE PERSONAL COMPUTER CARREL, ON METAL FRAME, WITH FROSTED GLASS SCREEN, 264" X 48" X 30"	\$12,995	\$10,396
0101	1	042		1	WOOD LAMINATE PERSONAL COMPUTER CARREL, ON STAINED AND VARNISHED SINGLE PEDESTAL BASE, WITH FROSTED GLASS SCREEN, 72" DIAMETER X 30"	\$4,600	\$3,680
0101	1	042		1	LOT OF PERSONAL COMPUTER TABLES	\$5,000	\$4,000



# Industrial Appraisal Company

Elmhurst Public Library

## Contents

Valuation Date: 3/12/2024

BLDG	FLOOR	CLASS	ITEM ID NO	QTY	DESCRIPTION	CRN	SOUND
0101	1	042	1	1	WOOD LAMINATE TABLE, ON METAL LEG BASE, 120" X 30" X 36"	\$1,500	\$1,200
0101	1	042	7	7	WOOD LAMINATE TABLES, 69" X 36" X 29"	\$5,250	\$4,200
0101	1	042	1	1	WOOD LAMINATE HALF ROUND TABLE, 84" X 36" X 29"	\$895	\$716
0101	1	042	16	16	WOOD LAMINATE TABLES, 36" DIAMETER X 29"	\$9,520	\$7,616
0101	1	042	1	1	WOOD LAMINATE OVOID TABLE, ON METAL DOUBLE PEDESTAL BASE, 84" X 30" X 29"	\$1,195	\$956
0101	1	042	1	1	WOOD LAMINATE ENTERTAINMENT CABINET, 144" X 24" X 30", METAL LEG BASE	\$1,995	\$1,397
0101	1	042	2	2	STAINED AND VARNISHED SLAT FACED DISPLAY, DOUBLE SIDED, 48" X 54" X 18", CASTER BASE	\$2,790	\$2,232
0101	1	042	2	2	METAL ROTARY MAGAZINE DISPLAYS, CASTER BASE, 3 TIERS, 4 SIDED	\$1,990	\$1,592
0101	1	042	1	1	LOT OF MISCELLANEOUS MINOR EQUIPMENT	\$33,750	\$23,625
0101	1	043	14	14	LOUNGE CHAIRS, VINYL UPHOLSTERED, ON STAINED AND VARNISHED LEG BASE	\$19,530	\$11,718
0101	1	043	5	5	SOFAS, VINYL UPHOLSTERED, ON STAINED AND VARNISHED LEG BASE	\$12,475	\$7,485
0101	1	043	15	15	OTTOMANS, FABRIC UPHOLSTERED, 36" DIAMETER, METAL LEG BASE	\$8,925	\$5,355
0101	1	043	8	8	CORNER FIT LOUNGE CHAIRS, FABRIC UPHOLSTERED, ON METAL LEG BASE	\$11,160	\$6,696
0101	1	043	2	2	BENCHES, FABRIC AND VINYL UPHOLSTERED, METAL LEG BASE, 5 SECTIONS	\$15,000	\$9,000
0101	1	043	2	2	LOUNGE CHAIRS, VINYL AND FABRIC UPHOLSTERED, HIGH BACK	\$3,590	\$2,154
0101	1	043	1	1	CURVED BENCH, FABRIC AND VINYL UPHOLSTERED, METAL LEG BASE, 12 LINEAL FEET, WITH HIGH BACK, WITH WOOD LAMINATE REAR TABLE	\$3,995	\$2,397
0101	1	043	1	1	MODULAR SEATING SYSTEM, VINYL UPHOLSTERED, ON METAL FRAME, CONSISTING OF	\$12,500	\$7,500
0101	1	043		5 - BENCHES			
0101	1	043		2 - STOOLS			
0101	1	043		7 - SEAT BACKS			
0101	1	043		3 - SEAT BACKS, CORNER FIT			
0101	1	043		4 - ARM DIVIDERS			
0101	1	043		9 - OTTOMANS			
0101	1	045	1	1	LG TV, 60"	\$800	\$480
0101	1	046	25	25	LENOVO WORKSTATIONS, WITH MONITOR, KEYBOARD AND MOUSE	\$26,250	\$15,750
0101	1	046	4	4	ASUS EARLY LITERARY STATIONS	\$10,000	\$6,000



# Industrial Appraisal Company

Elmhurst Public Library

## Contents

Valuation Date: 3/12/2024

BLDG	FLOOR	CLASS	ITEM ID NO	QTY	DESCRIPTION	CRN	SOUND
0101	1	046		1	HP COLOR LASERJET ENTERPRISE M652 PRINTER	\$4,150	\$2,490
0101	1	046		1	IVINA FB62801 BOOK SCANNING SYSTEM, WITH TOUCH SCREEN CONTROL, WITH TBS AD290 SHEET SCANNER	\$10,995	\$6,597
0101	1	046		1	BIBLIOTHECA SELF-CHECKOUT SYSTEM, FLOOR STANDING TYPE, WITH TBS PAY STATION	\$29,995	\$17,997
0101	1				<u>KIDS PROGRAM ROOM</u>		
0101	1	042		1	LOT OF MISCELLANEOUS MINOR EQUIPMENT	\$6,820	\$4,092
0101	1	045		1	SOUND AND VIDEO SYSTEM, CONSISTING OF	\$15,000	\$9,000
0101	1	045		1	1 - DELL INTERACTIVE BOARD		
0101	1	045		1	1 - CROWN AMPLIFIER		
0101	1	045		1	1 - CRESTRON CONTROLLER		
0101	1	045			WITH SPEAKERS, CABLES, CONNECTORS, WIRELESS MICROPHONE KITS, ETC.		
0101	1				<u>CHILDRENS OFFICE</u>		
0101	1	021		1	PAINTED STEEL LIBRARY SHELF UNIT, 33 LINEAL FEET X 7' X 1'	\$7,040	\$5,632
0101	1	021		2	PAINTED STEEL AND WOOD LAMINATE MODULAR DESK UNITS, 5 STATIONS	\$50,000	\$40,000
0101	1	021		2	PAINTED STEEL AND WOOD LAMINATE U SHAPED MODULAR DESK UNITS, SINGLE STATION, WITH 2 TIER OVERSHELF	\$10,000	\$8,000
0101	1	042		5	PAINTED STEEL 3 DRAWER LATERAL FILES, 36"	\$4,475	\$3,580
0101	1	042		2	PAINTED STEEL 6 DRAWER AUDIO-VISUAL FILES, 42"	\$3,390	\$2,712
0101	1	042		1	PAINTED STEEL 1 DOOR IPAD CHARGING CABINET, 3 TIERS, 24" X 24" X 42"	\$2,095	\$1,676
0101	1	042		1	LOT OF MISCELLANEOUS MINOR EQUIPMENT	\$12,100	\$7,260
0101	1	044		1	RICOH IMC3000 COPIER	\$12,000	\$7,200
0101	1	044		1	GBC ULTIMA 65 LAMINATOR	\$3,320	\$1,992
0101	1	046		2	DELL LAPTOP COMPUTERS, WITH MONITOR, KEYBOARD, MOUSE AND PRINTER	\$3,100	\$1,860
0101	1	046		1	DELL LAPTOP COMPUTER	\$1,000	\$600
0101	1	046		1	HP WORKSTATION, WITH MONITOR, KEYBOARD AND MOUSE	\$1,050	\$630
0101	1	046		7	HP WORKSTATIONS, WITH 2 MONITORS, KEYBOARD AND MOUSE	\$8,750	\$5,250
0101	1	046		1	HP WORKSTATION, WITH 2 MONITORS, KEYBOARD, MOUSE AND BARCODE READER	\$1,550	\$930
0101	1	046		1	MAKERBOT REPLICATOR PLUS 3D PRINTER	\$2,100	\$1,260



# Industrial Appraisal Company

Elmhurst Public Library

## Contents

Valuation Date: 3/12/2024

BLDG	FLOOR	CLASS	ITEM ID NO	QTY	DESCRIPTION	CRN	SOUND
0101	1				<b>CIRCULATION WORKROOM</b>		
0101	1	021		1	PAINTED STEEL LIBRARY SHELF UNIT, 27 LINEAL FEET X 7' X 1'	\$5,760	\$4,608
0101	1	021		2	PAINTED STEEL LIBRARY SHELF UNITS, 9 LINEAL FEET X 7' X 1'	\$3,840	\$3,072
0101	1	042		2	PAINTED STEEL AND WOOD LAMINATE U SHAPED MODULAR DESK UNITS, SINGLE STATION	\$10,000	\$8,000
0101	1	042		2	PAINTED STEEL AND WOOD LAMINATE MODULAR DESK UNITS, DOUBLE STATION	\$20,000	\$16,000
0101	1	042		1	PAINTED STEEL AND WOOD LAMINATE MODULAR DESK UNIT, 3 STATIONS	\$15,000	\$12,000
0101	1	042		3	METAL LOWERATOR RETURN BINS, 25" X 25" X 29"	\$3,585	\$2,868
0101	1	042		1	LOT OF MISCELLANEOUS MINOR EQUIPMENT	\$42,700	\$27,755
0101	1	044		1	RICOH IMC3000 COPIER	\$12,000	\$7,200
0101	1	046		2	DELL LAPTOP COMPUTERS, WITH MONITOR, KEYBOARD, MOUSE AND PRINTER	\$3,000	\$1,800
0101	1	046		1	DELL PERSONAL COMPUTER, WITH MONITOR, KEYBOARD AND MOUSE	\$1,500	\$900
0101	1	046		7	DELL WORKSTATIONS, WITH MONITOR, KEYBOARD, MOUSE, BARCODE READER, RECEIPT PRINTER AND RFID PAD	\$29,050	\$17,430
0101	1	046		2	DELL WORKSTATIONS, WITH 2 MONITORS, KEYBOARD, MOUSE, BARCODE READER AND HP LASERJET PRO M402DNE PRINTER	\$8,900	\$5,340
0101	1	046		1	DELL WORKSTATION, WITH MONITOR, KEYBOARD, MOUSE AND LABEL PRINTER	\$1,550	\$930
0101	1	046		1	DELL WORKSTATION, WITH 2 MONITORS, KEYBOARD, MOUSE AND BARCODE READER	\$1,550	\$930
0101	1	046		1	ECO MASTER DISC REPAIR SYSTEM	\$6,995	\$4,197
0101	1	046		1	BIBLIOTHECA SELF-RETURN STATION, 2 KIOSKS, WITH 18 LINEAL FEET OF AUTOMATED CONVEYOR BELT, WITH 10 LINEAL FEET OF AUTOMATED SORTER TABLE, WITH 9 LOWERATOR RETURN BINS, 36" X 24" X 36"	\$250,000	\$200,000
0101	1				<b>IT OFFICE</b>		
0101	1	042		1	STAINED AND VARNISHED OFFICE SUITE, CONSISTING OF	\$7,000	\$5,500
0101	1	042			2 - WORKTABLES, 72" X 30", WITH DOUBLE PEDESTAL BASE		
0101	1	042			1 - 4 DOOR CREDENZA, 72" X 24" X 30"		
0101	1	042			1 - BOOKCASE, 36" X 84" X 24"		
0101	1	042			3 - WALL CABINETS, 72" X 18" X 18"		
0101	1	042		1	LOT OF MISCELLANEOUS MINOR EQUIPMENT	\$1,145	\$802
0101	1	046		1	DELL LAPTOP COMPUTER, WITH 2 MONITORS, KEYBOARD AND MOUSE	\$1,250	\$750
0101	1	046		1	HP WORKSTATION, WITH 2 MONITORS, KEYBOARD AND MOUSE	\$1,050	\$630
0101	1				<b>FACILITIES MANAGERS OFFICE</b>		
0101	1	042		1	PAINTED STEEL AND WOOD LAMINATE L SHAPED MODULAR DESK UNIT	\$5,000	\$4,000
0101	1	042		1	LOT OF MISCELLANEOUS MINOR EQUIPMENT	\$1,285	\$771
0101	1	046		1	DELL LAPTOP COMPUTER, WITH MONITOR, KEYBOARD, MOUSE AND HP LASERJET PRO M402DNE PRINTER	\$1,550	\$930



# Industrial Appraisal Company

Elmhurst Public Library

## Contents

Valuation Date: 3/12/2024

BLDG	FLOOR	CLASS	ITEM ID NO	QTY	DESCRIPTION	CRN	SOUND
0101	1				<u>BUILDING AND GROUNDS OFFICE</u>		
0101	1	021		1	LOT OF PAINTED STEEL SHELVING, 7 TIERS, 33 LINEAL FEET X 7' X 1'	\$6,325	\$5,060
0101	1	042		1	PAINTED STEEL AND WOOD LAMINATE L SHAPED MODULAR DESK UNIT	\$5,000	\$4,000
0101	1	042		1	LOT OF MISCELLANEOUS MINOR EQUIPMENT	\$500	\$300
0101	1	046		1	HP WORKSTATION, WITH 2 MONITORS, KEYBOARD AND MOUSE	\$1,250	\$750
0101	1	051		1	SAMSUNG WHITE ENAMELED METAL LAUNDRY PAIR	\$1,750	\$1,050
0101	1	072		1	LOT OF HAND TOOLS, POWER TOOLS, ETC.	\$2,350	\$1,410
0101	1				<u>TECHNICAL SERVICES OFFICE</u>		
0101	1	021		2	PAINTED STEEL LIBRARY SHELF UNITS, 15 LINEAL FEET X 7' X 1'	\$6,400	\$5,120
0101	1	021		3	PAINTED STEEL LIBRARY SHELF UNITS, 9 LINEAL FEET X 7' X 1'	\$5,760	\$4,608
0101	1	021		1	PAINTED STEEL AND WOOD LAMINATE U SHAPED MODULAR DESK UNIT	\$5,000	\$4,000
0101	1	021		1	PAINTED STEEL AND WOOD LAMINATE MODULAR DESK UNIT, 4 STATIONS	\$20,000	\$16,000
0101	1	021		1	PAINTED STEEL AND WOOD LAMINATE MODULAR DESK UNIT, 6 STATIONS	\$30,000	\$24,000
0101	1	042		1	STAINED AND VARNISHED WOOD TABLE, LAMINATE TOP, ON METAL LEG BASE, 72" X 30"	\$995	\$796
0101	1	042		1	WOOD LAMINATE TABLE, ON STAINED AND VARNISHED LEG BASE, 72" X 42"	\$695	\$556
0101	1	042		1	LOT OF MISCELLANEOUS MINOR EQUIPMENT	\$14,160	\$8,496
0101	1	046		1	HP WORKSTATION, WITH 2 MONITORS, KEYBOARD, MOUSE AND BARCODE READER	\$1,550	\$930
0101	1	046		2	HP WORKSTATIONS, WITH 2 MONITORS, KEYBOARD, MOUSE AND PRINTER	\$3,700	\$2,220
0101	1	046		3	HP WORKSTATIONS, WITH 2 MONITORS, KEYBOARD, MOUSE, LABEL PRINTER, RECEIPT PRINTER AND RFID PAD	\$14,550	\$8,730
0101	1	046		2	HP WORKSTATIONS, WITH 2 MONITORS, KEYBOARD, MOUSE AND LABEL PRINTER	\$4,100	\$2,460
0101	1	046		1	HP WORKSTATION, WITH 2 MONITORS, KEYBOARD, MOUSE AND PRINTER	\$1,850	\$1,110
0101	1	046		1	DELL LAPTOP COMPUTER, WITH MONITOR, KEYBOARD, MOUSE AND PRINTER	\$1,550	\$930
0101	1	046		1	HP COLOR LASERJET PRO MFP476DN PRINTER	\$500	\$300
0101	1				<u>STAFF LOUNGE</u>		
0101	1	043		4	MODERN LOUNGE CHAIRS, VINYL UPHOLSTERED, ON STAINED AND VARNISHED LEG BASE, WITH OTTOMAN	\$7,980	\$4,788
0101	1	043		1	WOOD LAMINATE DINING TABLE, ON METAL DOUBLE PEDESTAL AND STRETCHER BASE, 84" X 36"	\$695	\$556
0101	1	046		1	DELL LAPTOP COMPUTER	\$1,000	\$600
0101	1	051		2	SAMSUNG STAINLESS STEEL REFRIGERATOR/FREEZERS, 2 DOORS OVER DRAWER, 24 CUBIC FEET	\$5,790	\$3,474
0101	1	051		1	LOT OF MISCELLANEOUS MINOR EQUIPMENT	\$6,475	\$3,885



BLDG	FLOOR	CLASS	ITEM ID NO	QTY	DESCRIPTION	CRN	SOUND
0101	1				<u>RECEIVING AREA</u>		
0101	1	042		2	GALVANIZED STEEL LOWERATOR BINS, 36" X 42" X 46"	\$2,790	\$2,232
0101	1	042		1	LOT OF MISCELLANEOUS MINOR EQUIPMENT	\$3,890	\$2,334
0101	1	065		1	VENTRAC 3400Y TRACTOR, WITH 72" SNOW BRUSH, 60" SALT HOPPER, 60" PLOW, 42" SNOW BRUSH	\$36,995	\$22,197
0101	1				<u>RECEPTIONISTS AREA</u>		
0101	1	042		1	U SHAPED RECEPTIONISTS MODULAR DESK UNIT	\$6,000	\$4,800
0101	1	042		4	PAINTED STEEL 5 DRAWER LATERAL FILES, 36"	\$4,780	\$3,824
0101	1	042		1	LOT OF MISCELLANEOUS MINOR EQUIPMENT	\$1,200	\$720
0101	1	043		1	W.T. VAN DORN TALL CLOCK, STAINED AND VARNISHED AND ENAMELED WOOD CONSOLE, 1900	\$3,995	\$2,397
0101	1	044		1	NEOPOST IX-3 SERIES POSTAGE METER	\$3,995	\$2,397
0101	1	046		1	DELL LAPTOP COMPUTER, WITH MONITOR, KEYBOARD, MOUSE AND PRINTER	\$1,350	\$930
0101	1				<u>HUMAN RESOURCES OFFICE</u>		
0101	1	042		1	PAINTED STEEL AND WOOD LAMINATE SINGLE PEDESTAL DESK, WITH CONNECTOR AND RETURN	\$3,995	\$3,196
0101	1	042		4	PAINTED STEEL 5 DRAWER LATERAL FILES, 36"	\$4,780	\$3,824
0101	1	042		1	LOT OF MISCELLANEOUS MINOR EQUIPMENT	\$580	\$348
0101	1	046		1	DELL LAPTOP COMPUTER, WITH MONITOR, KEYBOARD, MOUSE AND SCANNER	\$1,550	\$930
0101	1				<u>COPY ROOM</u>		
0101	1	042		1	LOT OF MISCELLANEOUS MINOR EQUIPMENT	\$1,395	\$837
0101	1	044		1	RICOH IMC4500 COPIER	\$20,000	\$12,000
0101	1	051		1	LG STAINLESS STEEL REFRIGERATOR/FREEZER, 2 DOORS OVER 2 DRAWERS, 24 CUBIC FEET	\$2,895	\$1,737
0101	1				<u>CONFERENCE ROOM</u>		
0101	1	042		1	SET OF 6 STAINED AND VARNISHED CONFERENCE TABLES, ON METAL LEG BASE, 72" X 30"	\$5,400	\$4,320
0101	1	042		1	STAINED AND VARNISHED 6 DOOR CREDENZA, 72" X 30" X 24"	\$2,995	\$2,396
0101	1	042		1	SET OF 14 SWIVEL OPEN ARM CONFERENCE CHAIRS, FABRIC UPHOLSTERED, CASTER BASE	\$7,000	\$4,550
0101	1	046		1	DELL INTERACTIVE BOARD, 6' X 4'	\$2,330	\$1,398
0101	1				<u>LIBRARY DIRECTORS OFFICE</u>		
0101	1	042		1	PAINTED STEEL AND WOOD LAMINATE L SHAPED MODULAR DESK UNIT	\$5,000	\$4,000
0101	1	042		1	LOT OF MISCELLANEOUS MINOR EQUIPMENT	\$2,520	\$1,512
0101	1	046		1	DELL LAPTOP COMPUTER, WITH MONITOR, KEYBOARD, MOUSE AND PRINTER	\$1,550	\$930



# Industrial Appraisal Company

Elmhurst Public Library

## Contents

Valuation Date: 3/12/2024

BLDG	FLOOR	CLASS	ITEM ID NO	QTY	DESCRIPTION	CRN	SOUND
0101	1				<u>ASSISTANT DIRECTORS OFFICE</u>		
0101	1	042		1	PAINTED STEEL AND WOOD LAMINATE U SHAPED MODULAR DESK UNIT	\$5,000	\$4,000
0101	1	042		1	LOT OF MISCELLANEOUS MINOR EQUIPMENT	\$2,305	\$1,614
0101	1	046		1	DELL LAPTOP COMPUTER, WITH MONITOR, KEYBOARD, MOUSE AND PRINTER	\$1,550	\$930
0101	1				<u>MARKETING DEPARTMENT</u>		
0101	1	042		1	PAINTED STEEL AND WOOD LAMINATE U SHAPED MODULAR DESK UNIT	\$5,000	\$4,000
0101	1	042		1	PAINTED STEEL AND WOOD LAMINATE MODULAR DESK UNIT, 4 STATIONS	\$20,000	\$16,000
0101	1	042		1	LOT OF MISCELLANEOUS MINOR EQUIPMENT	\$4,105	\$2,463
0101	1	044		1	CANON IMAGE PRESS LITE C170 COPIER	\$45,000	\$27,000
0101	1	046		1	APPLE MACBOOK	\$1,500	\$900
0101	1	046		4	APPLE STATIONS, WITH MONITOR, KEYBOARD AND MOUSE	\$10,000	\$6,000
0101	1	046		1	APPLE MACBOOK, WITH MONITOR, KEYBOARD AND MOUSE	\$2,000	\$1,200
0101	1	046		1	CANON IMAGEPROGRAF PRO 4100S PRINTER	\$6,000	\$3,600
0101	2				<u>ADULT LIBRARY</u>		
0101	2	021		5	PAINTED STEEL LIBRARY SHELF UNITS, 30 LINEAL FEET X 7' X 2', WITH STAINED AND VARNISHED SLAT FACED ENDS, WITH TOP LIGHTING	\$76,250	\$61,000
0101	2	021		1	PAINTED STEEL LIBRARY SHELF UNIT, 30 LINEAL FEET X 7' X 2', WITH STAINED AND VARNISHED SLAT FACED ENDS	\$10,250	\$8,200
0101	2	021		12	PAINTED STEEL LIBRARY SHELF UNITS, 33 LINEAL FEET X 7' X 2', WITH STAINED AND VARNISHED SLAT FACED ENDS	\$134,700	\$107,760
0101	2	021		8	PAINTED STEEL LIBRARY SHELF UNITS, 33 LINEAL FEET X 7' X 2', WITH STAINED AND VARNISHED SLAT FACED ENDS, WITH TOP LIGHTING	\$133,800	\$107,040
0101	2	021		1	PAINTED STEEL LIBRARY SHELF UNIT, 24 LINEAL FEET X 7' X 2', WITH STAINED AND VARNISHED SLAT FACED ENDS	\$8,300	\$6,640
0101	2	021		3	PAINTED STEEL LIBRARY SHELF UNITS, 24 LINEAL FEET X 6 1/2' X 2', WITH STAINED AND VARNISHED SLAT FACED ENDS	\$21,150	\$16,920
0101	2	021		3	PAINTED STEEL LIBRARY SHELF UNITS, 21 LINEAL FEET X 6 1/2' X 2', WITH STAINED AND VARNISHED SLAT FACED ENDS	\$18,675	\$14,940
0101	2	021		4	PAINTED STEEL LIBRARY SHELF UNITS, 18 LINEAL FEET X 5 1/2' X 2', WITH STAINED AND VARNISHED SLAT FACED ENDS	\$17,800	\$14,240
0101	2	021		1	PAINTED STEEL LIBRARY SHELF UNIT, 12 LINEAL FEET X 5 1/2' X 2', WITH STAINED AND VARNISHED SLAT FACED ENDS	\$3,100	\$2,480
0101	2	021		3	PAINTED STEEL LIBRARY DISPLAY SHELF UNITS, 24 LINEAL FEET X 2 1/2' X 6', TAPERED, WITH STAINED AND VARNISHED SLAT FACED ENDS	\$22,260	\$17,808
0101	2	021		1	PAINTED STEEL LIBRARY DISPLAY SHELF UNIT, 21 LINEAL FEET X 2 1/2' X 6', WITH STAINED AND VARNISHED SLAT FACED ENDS	\$6,455	\$5,164



# Industrial Appraisal Company

Elmhurst Public Library

## Contents

Valuation Date: 3/12/2024

BLDG	FLOOR	CLASS	ITEM ID NO	QTY	DESCRIPTION	CRN	SOUND
0101	2	021		1	PAINTED STEEL LIBRARY DISPLAY SHELF UNIT, 18 LINEAL FEET X 2 1/2' X 6', WITH STAINED AND VARNISHED SLAT FACED ENDS	\$5,640	\$4,512
0101	2	021		5	PAINTED STEEL LIBRARY DISPLAY SHELF UNITS, 18 LINEAL FEET X 5 1/2' X 2', TAPERED, WITH 3 STAINED AND VARNISHED ENDS, WITH WOOD LAMINATE WEDGE	\$26,750	\$21,400
0101	2	021		1	PAINTED STEEL LIBRARY SHELF UNIT, 24 LINEAL FEET X 7' X 1', WITH STAINED AND VARNISHED ENDS	\$5,470	\$4,376
0101	2	021		4	PAINTED STEEL AUDIO-VISUAL LIBRARY DISPLAY SHELF UNITS, 27 LINEAL FEET X 5 1/2' X 2 1/2' TAPERED, WITH STAINED AND VARNISHED ENDS	\$37,500	\$30,000
0101	2	021		1	PAINTED STEEL AUDIO-VISUAL LIBRARY DISPLAY SHELF UNIT, 24 LINEAL FEET X 5 1/2' X 2 1/2', TAPERED, WITH STAINED AND VARNISHED ENDS	\$8,400	\$6,720
0101	2	021		1	PAINTED STEEL AUDIO-VISUAL LIBRARY DISPLAY SHELF UNIT, 12 LINEAL FEET X 5 1/2' X 2 1/2', TAPERED, WITH STAINED AND VARNISHED ENDS	\$4,500	\$3,600
0101	2	021		1	STAINED AND VARNISHED DISPLAY CASE, WITH CABINET BASE, 18' X 6'6" X 1'3"	\$14,625	\$11,700
0101	2	021		1	STAINED AND VARNISHED RECESSED DISPLAY CASE, 8' X 5' X 2', INTEGRAL LIT	\$7,000	\$5,600
0101	2	021		1	PAINTED STEEL LIBRARY SHELF UNIT, 12 LINEAL FEET X 7' X 1', WITH STAINED AND VARNISHED ENDS	\$2,910	\$2,328
0101	2	021		2	PAINTED STEEL LIBRARY SHELF UNITS, 6 LINEAL FEET X 7' X 1', WITH STAINED AND VARNISHED ENDS	\$3,260	\$2,608
0101	2	021		2	PAINTED STEEL LIBRARY SHELF UNITS, 3 LINEAL FEET X 7' X 1', WITH STAINED AND VARNISHED ENDS	\$1,980	\$1,584
0101	2	021		1	STAINED AND VARNISHED CURVED LIBRARIANS DESK, STONE TOP, 2 SECTIONS, 12 LINEAL FEET	\$12,000	\$9,600
0101	2	021		1	STAINED AND VARNISHED LIBRARIANS DESK, 3 SECTIONS, 20 LINEAL FEET	\$20,000	\$16,000
0101	2	042		27	STAINED AND VARNISHED TABLES, ON METAL LEG BASE, 48" X 40" X 29"	\$18,765	\$15,012
0101	2	042		10	STAINED AND VARNISHED TABLES, ON METAL LEG BASE, 72" X 30" X 24", WITH TOP LIGHT	\$9,950	\$7,960
0101	2	042		3	OTTOMANS, FABRIC UPHOLSTERED, HEXAGON SHAPED, ON SINGLE PEDESTAL BASE	\$2,085	\$1,251
0101	2	042		1	STAINED AND VARNISHED STUDY CARREL, 36" X 24", SINGLE STATION	\$1,695	\$1,356
0101	2	042		1	STAINED AND VARNISHED STUDY CARREL, 72" X 24", DOUBLE STATION	\$2,495	\$1,996
0101	2	042		4	STAINED AND VARNISHED TABLES, ON SINGLE PEDESTAL BASE, 60" DIAMETER	\$3,580	\$2,864
0101	2	042		6	STAINED AND VARNISHED PERSONAL COMPUTER CARRELS, ON METAL LEG BASE, 4 STATIONS, 84" X 48", WITH TOP LIGHTS	\$23,970	\$19,176
0101	2	042		4	MODULAR STUDY CARRELS, WITH 3 SCREENS AND 3 TABLES, CASTER BASE	\$20,800	\$16,640
0101	2	042		8	STAINED AND VARNISHED PERSONAL COMPUTER TALBES, ON METAL DOUBLE PEDESTAL BASE, 72" X 24"	\$7,160	\$5,728
0101	2	042		1	STAINED AND VARNISHED CONFERENCE TABLE, ON METAL DOUBLE PEDESTAL BASE, 8' X 3'	\$2,400	\$1,920
0101	2	042		8	OPEN ARM CONFERENCE CHAIRS, NAUGAHYDE UPHOLSTERED	\$7,960	\$4,776





BLDG	FLOOR	CLASS	ITEM ID NO	QTY	DESCRIPTION	CRN	SOUND
0101	2	042		6	BENCHES, VINYL UPHOLSTERED, ON METAL LEG BASE, 60"	\$5,370	\$3,222
0101	2	042		2	BENCHES, VINYL UPHOLSTERED, ON METAL LEG BASE, 60", DOUBLE SIDED	\$2,390	\$1,434
0101	2	042		1	LOT OF MISCELLANEOUS MINOR EQUIPMENT	\$48,540	\$33,978
0101	2	043		2	SOFAS, NAUGAHYDE UPHOLSTERED, ON METAL LEG BASE	\$8,000	\$4,800
0101	2	043		8	LOUNGE CHAIRS, NAUGAHYDE UPHOLSTERED, ON METAL LEG BASE	\$16,000	\$9,600
0101	2	043		12	LOUNGE CHAIRS, FABRIC UPHOLSTERED, ON METAL LEG BASE	\$16,800	\$10,080
0101	2	043		11	LOUNGE CHAIRS, FABRIC UPHOLSTERED, ON STAINED AND VARNISHED LEG BASE	\$14,300	\$8,580
0101	2	043		12	LOUNGE CHAIRS, FABRIC UPHOLSTERED, ON STAINED AND VARNISHED LEG BASE, HIGH BACK	\$21,540	\$12,924
0101	2	043		2	LOUNGE CHAIRS, FABRIC UPHOLSTERED, ON METAL PEDESTAL BASE	\$2,390	\$1,434
0101	2	043		4	LOVE SEATS, TO MATCH PREVIOUS ITEM	\$9,980	\$5,988
0101	2	043		4	LOVE SEATS, WITH PLASTIC AND FABRIC REFLECTIVE BACK AND CANOPY	\$15,980	\$9,588
0101	2	044		1	ST IMAGINE VIEW SCAN 4 MICROFILM READER, WITH PERSONAL COMPUTER, MONITOR, KEYBOARD AND MOUSE	\$5,000	\$3,000
0101	2	044		2	RICOH IMC3000 COPIERS, WITH TBS PAY STATION	\$30,000	\$18,000
0101	2	044		1	LVI BOOK MAGNIFIER	\$1,495	\$897
0101	2	045		1	BENQ LCD PROJECTOR	\$3,995	\$2,397
0101	2	046		48	HP WORKSTATIONS, WITH MONITOR, KEYBOARD AND MOUSE	\$50,400	\$30,240
0101	2	046		1	HP ALL-IN-ONE PERSONAL COMPUTER, WITH KEYBOARD AND MOUSE	\$1,500	\$900
0101	2	046		1	HP LASERJET ENTERPRISE M610 PRINTER	\$1,600	\$960
0101	2	046		1	BIBLIOTHECA FLOOR-STANDING SELF-CHECKOUT SYSTEM	\$25,000	\$15,000
0101	2	046		1	HP COLOR LASERJET ENTERPRISE M750 PRINTER, WITH TBS PAY STATION	\$5,700	\$3,420
0101	2	046		1	SIMPLE SCAN FB6280E BOOK SCANNING SYSTEM, WITH TOUCH SCREEN CONTROL, WITH AVISION AD240U SHEET SCANNER	\$10,995	\$6,597
0101	2	049		1	DEFIBTECH AED	\$1,500	\$900
0101	2				<u>GATHERING ROOM</u>		
0101	2	042		4	WOOD LAMINATE TABLES, ON METAL LEG AND CASTER BASE, 72" X 24"	\$3,200	\$2,560
0101	2	042		1	LOT OF 17 CONFERENCE CHAIRS, VINYL UPHOLSTERED	\$8,500	\$5,100
0101	2	042		1	LOT OF MISCELLANEOUS MINOR EQUIPMENT	\$1,930	\$1,158
0101	2	046		1	INFOCUS INTERACTIVE BOARD, 6' X 4', WALL MOUNTED	\$2,330	\$1,398



BLDG	FLOOR	CLASS	ITEM ID NO	QTY	DESCRIPTION	CRN	SOUND
0101	2				<b>STUDIO A</b>		
0101	2	042		2	FLOUGHT FL22AW STUDIO LIGHTS, ON STAND	\$2,400	\$1,440
0101	2	042		1	FLOUGHT FL110AW STUDIO LIGHT, ON STAND	\$1,000	\$600
0101	2	042		1	LOT OF MISCELLANEOUS MINOR EQUIPMENT	\$1,995	\$1,197
0101	2	046		1	APPLE WORKSTATION, WITH MONITOR, KEYBOARD, MOUSE, SCANNER, SPEAKERS, AMPLIFIER AND RECEIVER	\$5,000	\$3,000
0101	2	057		1	M-AUDIO OXYGEN 61 KEYBOARD	\$500	\$300
0101	2	057		1	ROLAND DIGITAL DRUM KIT	\$1,000	\$600
0101	2				<b>STUDIO B</b>		
0101	2	042		1	LOT OF MISCELLANEOUS MINOR EQUIPMENT	\$725	\$435
0101	2	046		1	APPLE WORKSTATION, WITH MONITOR, KEYBOARD, MOUSE, SCANNER, MODEM AND CONTROL PAD	\$3,000	\$1,800
0101	2				<b>STUDIO C</b>		
0101	2	042		1	LOT OF MISCELLANEOUS MINOR EQUIPMENT	\$725	\$435
0101	2	046		1	APPLE WORKSTATION, WITH MONITOR, KEYBOARD, MOUSE, SCANNER, MODEM AND CONTROL PAD	\$3,000	\$1,800
0101	2				<b>TEEN LIBRARY</b>		
0101	2	021		1	PAINTED STEEL LIBRARY SHELF UNIT, 12 LINEAL FEET X 7' X 1'	\$2,560	\$2,048
0101	2	021		1	PAINTED STEEL LIBRARY SHELF UNIT, 48 LINEAL FEET X 7' X 2', WITH WOOD LAMINATE ENDS	\$16,100	\$12,880
0101	2	021		2	PAINTED STEEL LIBRARY SHELF UNITS, 9 LINEAL FEET X 5 1/2' X 2', WITH 3 WOOD LAMINATE ENDS, WITH WOOD LAMINATE WEDGE	\$7,590	\$6,072
0101	2	042		1	LOT OF MISCELLANEOUS MINOR EQUIPMENT	\$2,880	\$2,016
0101	2				<b>TEEN ROOM</b>		
0101	2	021		1	WOOD LAMINATE CABINET, 12 LINEAL FEET X 6' X 2'	\$7,200	\$5,040
0101	2	021		1	BENCH, FABRIC AND VINYL UPHOLSTERED, 24 LINEAL FEET	\$4,800	\$3,360
0101	2	042		1	LOT OF MISCELLANEOUS MINOR EQUIPMENT	\$7,830	\$4,598
0101	2	043		4	GAMING LOUNGE CHAIRS, FABRIC UPHOLSTERED	\$2,780	\$1,668
0101	2	043		8	CORNER FIT LOUNGE CHAIRS, VINYL UPHOLSTERED	\$11,160	\$6,696
0101	2	046		4	HP WORKSTATIONS, WITH MONITOR, KEYBOARD AND MOUSE	\$4,200	\$2,520



BLDG	FLOOR	CLASS	ITEM ID NO	QTY	DESCRIPTION	CRN	SOUND
0101	2				ADULT SERVICES ROOM		
0101	2	021		1	PAINTED STEEL LIBRARY SHELF UNIT, 30 LINEAL FEET X 7' X 1'	\$6,375	\$5,100
0101	2	021		2	PAINTED STEEL AND WOOD LAMINATE U SHAPED MODULAR DESK UNITS	\$10,000	\$8,000
0101	2	021		1	PAINTED STEEL AND WOOD LAMINATE MODULAR DESK UNIT, 2 STATIONS	\$10,000	\$8,000
0101	2	021		2	PAINTED STEEL AND WOOD LAMINATE MODULAR DESK UNITS, 6 STATIONS	\$60,000	\$48,000
0101	2	042		1	LOT OF MISCELLANEOUS MINOR EQUIPMENT	\$11,340	\$6,804
0101	2	046		1	HP WORKSTATION, WITH MONITOR, KEYBOARD AND MOUSE	\$1,050	\$630
0101	2	046		8	HP WORKSTATIONS, WITH 2 MONITORS, KEYBOARD AND MOUSE	\$10,000	\$6,000
0101	2	046		2	HP WORKSTATIONS, WITH 2 MONITORS, KEYBOARD, MOUSE AND BARCODE READER	\$3,100	\$1,860
0101	2	046		2	DELL LAPTOP COMPUTERS, WITH MONITOR, KEYBOARD, MOUSE AND PRINTER	\$3,000	\$1,800
CONTENTS TOTAL						\$2,331,655	\$1,544,276
X CONTENTS TOTAL						\$4,424,015	\$4,424,015
FIXED CONTENTS TOTAL						\$1,779,560	\$1,373,244



BLDG	FLOOR	CLASS	ITEM ID NO	QTY	DESCRIPTION	CRN	SOUND
0199					<u>LIBRARY PITO</u>		
0199	O				<u>PROPERTY IN THE OPEN</u>		
0199	O	002		1	FLAGPOLE	\$8,500	\$6,800
0199	O	002		1	ALUMINUM PICKET FENCING	\$10,800	\$8,640
0199	O	002		1	WOOD STOCKADE FENCING	\$20,400	\$16,320
0199	O	002		1	LIGHTING	\$115,485	\$92,388
0199	O	002		1	SIGN	\$7,500	\$6,000
0199	O	010		1	BRONZE STATUE, MOTHER READING TO CHILDREN	\$10,000	\$9,000
0199	O	021		4	STEEL BICYCLE RACKS, 9 LINEAL FEET	\$4,000	\$3,200
0199	O	021		7	PAINTED STEEL BENCHES	\$13,965	\$11,172
0199	O	021		4	PAINTED STEEL TRASH RECEPTACLES	\$3,980	\$3,184
0199	O	021		3	PAINTED STEEL BUTTERFLY BENCHES	\$8,985	\$7,188
FIXED CONTENTS TOTAL						\$40,930	\$33,744
PROPERTY IN THE OPEN TOTAL						\$162,685	\$130,148



## Insurance Summary Report

### Elmhurst Public Library 125 S Prospect Ave Elmhurst, IL 60126

Building: 0101  
Library

Address: 125 S Prospect Ave  
Elmhurst, IL 60126

IAC Contract No: E5-1079  
IAC Revaluation No: 2156525  
Appraisal Date: 03/12/2024  
Valuation Date: 03/12/2024

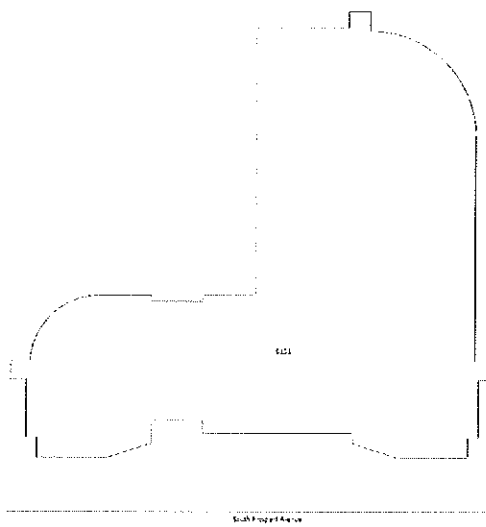

Building	Contents	Property in the Open	Grand Total
Cost of Reproduction New	Cost of Reproduction New	Cost of Reproduction New	Cost of Reproduction New
Less Exclusions		(Additional Building Cost)	
\$35,542,474	\$2,331,655	\$0	\$42,298,144
	X - \$4,424,015		

#### Building Description

Occupancy: Library  
Year(s) Built: 2003  
Super SQFT: 80,067  
Basement SQFT: 8,993  
Stories: 2  
ISO Class: Modified Fire Resistive  
Building Condition: Good

#### Additional Data

Sprinklers: 100%  
Central Fire Alarm System: 100%  
Security System: 100%  
Passenger Elevator: 2

#### Building Components

Exterior Wall Type: Curtain Wall, Glass / Stone on Masonry /  
Siding, Metal on Girts  
Heating: Steam and Hot Water to Air Handlers  
Cooling: Chilled Water w/ Air Handlers  
Roofing Material: Single-Ply Membrane / Tile, Concrete

#### Additional Features:

Canopies, Fireplace, Generator, Screen Wall with Sign, Signs



**Elmhurst Public Library**  
125 S Prospect Ave Elmhurst, IL 60126

**Building:** 0199  
Library PITO

**Address:** 125 S Prospect Ave  
Elmhurst, IL 60126

**IAC Contract No:** E5-1079  
**IAC Revaluation No:** 2156525  
**Appraisal Date:** 03/12/2024  
**Valuation Date:** 03/12/2024

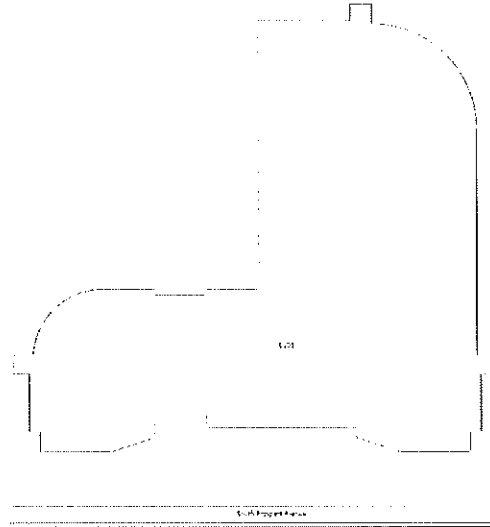
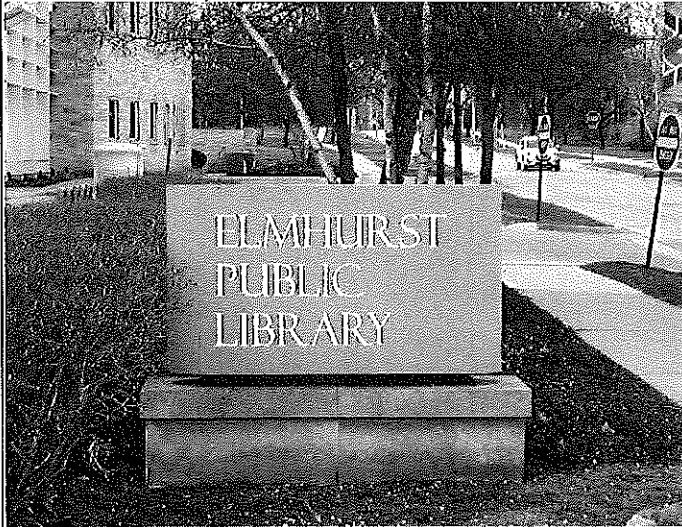

<b>Building</b>	<b>Contents</b>	<b>Property in the Open</b>	<b>Grand Total</b>
Cost of Reproduction New	Cost of Reproduction New	Cost of Reproduction New	Cost of Reproduction New
Less Exclusions		(Additional Building Cost)	
<b>\$40,930</b>	<b>\$0</b>	<b>\$162,685</b>	<b>\$203,615</b>

**Building Description**

**Occupancy:** Property in the Open

**Year(s) Built:**

**Super SQFT:**

**Stories:**

**ISO Class:**

**Building Condition:**

**Additional Data**

**Building Components**

**Exterior Wall Type:**

**Heating:**

**Cooling:**

**Roofing Material:**

**Additional Features:**

