

### Director's Report

- Repairs to the lobby elevator are complete. An inspector came out last week and gave us the green light for operation. The elevator was out of service for over a month, which was a minor inconvenience to patrons. During that time, patrons used the elevator in the Kids' Department. People were very understanding but it's good to have the lobby elevator operating again.
- It's Winter Reading time again and Adults can participate in a winter reading challenge to expand their reading comfort zone, while high schoolers can participate in a program to earn prizes for reading. The kids' theme is Reading is Sweet and prizes are earned after completing 20 days of reading and 40 days of reading.
- On Martin Luther King Day, patrons can participate in a day of service by participating in hands-on activities focused around the theme of creating warmth. The community-building event takes place in the Large Meeting Room and people of all ages and abilities are invited to attend.



### Entertainment Station

Angelina Mazenko launched our latest trial, the Entertainment Station. For years we've offered coloring books, knitting baskets and other activities on the floor. Instead of offering them in specific spots, we've created a station where patrons can find coloring books, crossword puzzles, sudoku and other activities for taking a break from their work.

### Artificial Intelligence

We're offering multiple AI programs. Christina Racibozynski collaborated with Alyssa Murphy and Jeremy Slayton on AI programming. They ran a lobby table in December and will offer another in January. These will be followed by programs called "Civics & Artificial Intelligence" in March and another called "Artificial Intelligence: Promise and Perils" in May. They're planning an additional AI class for the summer.

### Community Collaborations

Anne Swanson (ADS) and Jez Layman (Marketing) have been collaborating for the past several months on our community jigsaw puzzle. Patrons have taken a strong interest and completed several puzzles thus far. Kelsey Wilcoxon worked with the Marketing Department to offer patrons a community crossword puzzle this month for National Crossword Day.



### Representing EPL

Christi Hawn presented on a panel at ARRTCon in Naperville on Deepest Darkest RA Fears. The panelists gave advice on some of the more difficult aspects of readers advisory interactions.

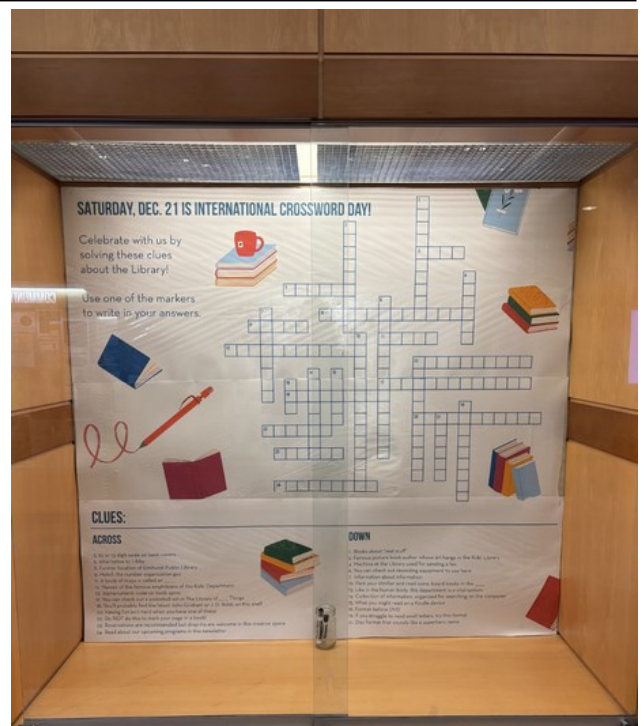
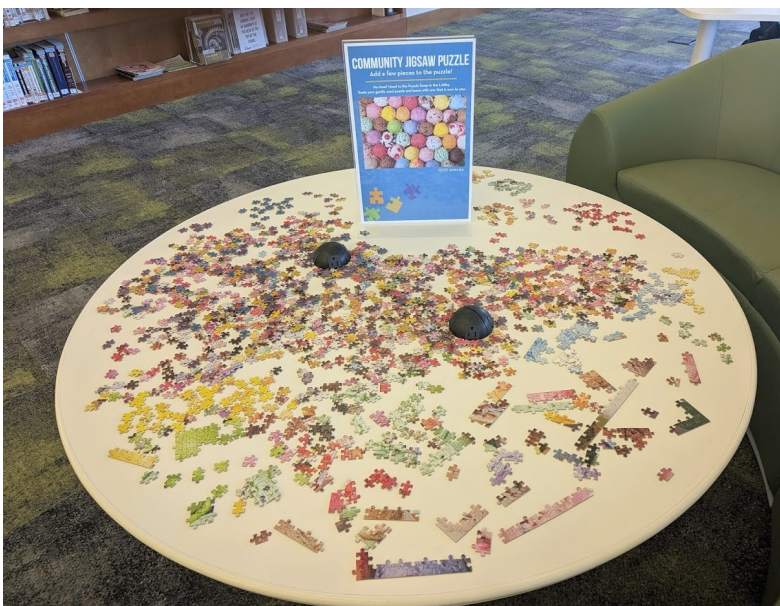



# KIDS' LIBRARY DEPT REPORT

December 2024

## Programming

The Winter Reading Program "Reading Is Sweet" debuted December 21. Kids' and Marketing staff had a lot of fun creating the sugary decorations.

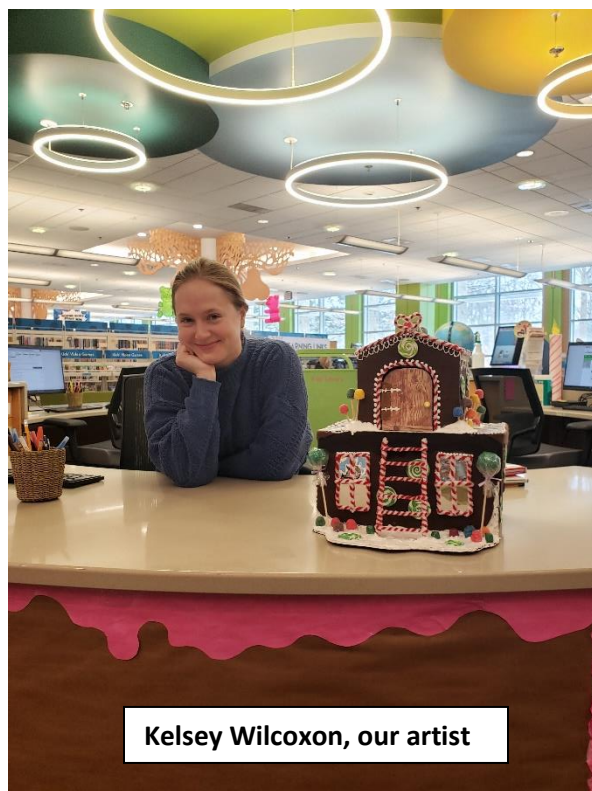
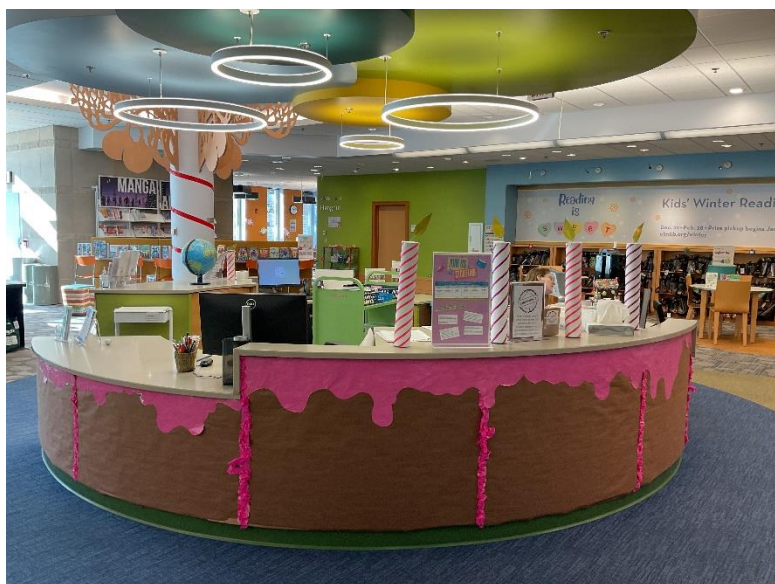

Kelsey Wilcoxon, our artist





The decorations engaged the children in a variety of fun ways. They could measure their height in gingerbread, guess how many cottonballs were in the snowman, and decorate a cookie for the bulletin board. For the winners of the Guess How Many jar, **Gabby Palomino** made mittens with removable designs for the children to decorate with.

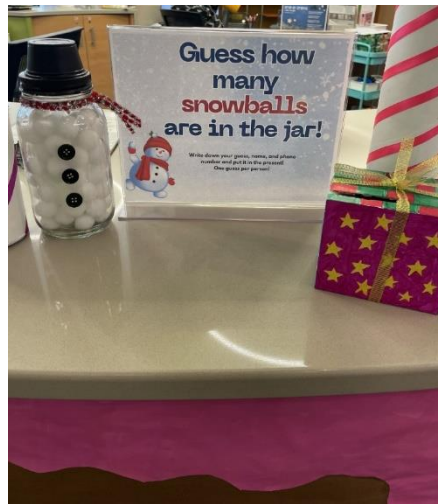

Other programming highlights included a rousing musical performance by Nanny Nikki, LEGO engineering, a New Year's Eve dance party, and the Polar Express storytime.



## Collection

It was a significant month for collection development. Erin Emerick used Library IQ to create weeding and shelf lists for the Kids selectors. This new product is easy to use and is proving to be very helpful as we continue to analyze the collection to "right size" it for the future. Mary Smith, Erin Emerick, and Katie Stringwell also received Ingram training. We will be transitioning to using Ingram as our primary ordering source in 2025.

## Middle School Happenings

It was an eventful month. In early December, Claire Mitchell and Brianne Rigitano held a very successful drop-in videogaming programming with eight middle schoolers who were using the hangout. On December 16, Angela Caringella began as our new Middle School Coordinator. Also this week, there were 3 day-long visits to the middle schools to promote the Winter Reading Program. The students loved playing candy jeopardy and hearing about new books.



## Department News

The Kids' workroom got new carpeting. All Kids staff worked hard to declutter and organize in preparation for the installation. The new carpet looks great!





# MARKETING DEPARTMENT REPORT December 2024

## December Marketing Topics included:

### Programming: Winter Reading: Reading is Sweet

Join our Winter Reading challenge for adults, high schoolers, and kids newborn-grade 8. For adults, choose from *Expand Your Reading Comfort Zone* or *Winter Reading with Beanstack: Choose Your Own Books*. For high schoolers, read or listen to a book to be entered to a prize drawing. For kids newborn-grade 8, pick up a log at Kids' Help Desk or print a log online to track days of reading. At 20 days of reading or listening, bring log to the Library to earn a prize. After 40 days of reading and listening, stop by the Library to receive your final prize.

### Collections: Hoopla Kids

Hoopla is for kids, too! Hoopla Kids Mode helps parents and their children discover kid-friendly digital content. When in Kids Mode, you'll only see content recommended for kids 12 and younger.

### Services: Explore More Illinois

Use Explore More Illinois for free or discounted admission to fun and educational places throughout the state. Explore More Illinois added these new attractions: Harris Theater for Music and Dance and Forest Park Nature Center.

### Inside Scoop: Winter Stitch-Along

Winter Stitch-Along is a mystery cross-stitch pattern where new parts of the design are released each week. Every Sunday, we send you the next piece until you have a completed pattern.

**Here are some sample screenshots of our online presence from December:**

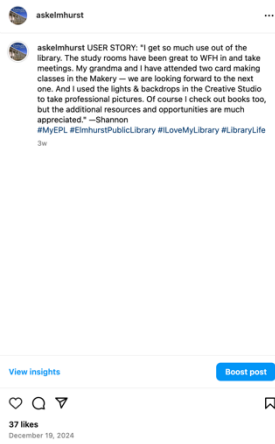

**In December, people watched your videos 21,710 times**



eNews from 12/19

Elmhurst Community Blood Drive  
Thursday, Dec. 26 • 11 a.m.-4 p.m. • Large Meeting Room  
[Make an appointment with Vitalant](#); walk-ins welcome

---

### Winter Reading: Dec. 21-Feb. 28

**Reading is SWEET**

Starting Saturday, get ready to read or listen to books for a chance to win prizes:

**Kids (Newborn-Gr. 8)**  
Winter Reading: Reading is Sweet

**Teens Gr. 9-12**  
Choose your preferred format: print, eBook, audiobook, graphic novel, or manga. Any book counts!

**Adults**  
Take the Winter Reading Challenge by reading a book you may not typically choose — [we choose it for you](#).

Or, choose your own book and track it using Beanstack, available at [elmlib.org/beanstack](http://elmlib.org/beanstack) or as an app for your phone.

Winter Reading

### Holiday Hours

This month, the Makery is open an extra day so you can get your projects done for the holidays!

**Makery Seasonal Hours**  
Monday, Dec. 23 • 10 a.m.-8:30 p.m.  
[See regular Makery hours here.](#)

**Library Holiday Hours**  
Tuesday, Dec. 24 - CLOSED  
Wednesday, Dec. 25 - CLOSED  
Tuesday, Dec. 31 - Library closes at 5 p.m.  
Wednesday, Jan. 1 - CLOSED

---

### Kanopy's Holiday Movies

**Home Viewing for the Holidays**

Whether you're looking for kid-friendly content to entertain the whole family or holiday-themed films to get into the seasonal spirit, Kanopy has got you covered with their [Home Viewing for the Holidays](#) collection.

Snuggle up by [Kanopy's Festive Fireplace](#) this December and bask in the warmth and glow of the season!

Watch

#HomeViewingForTheHolidays

#KanopyViewingForTheHolidays



Reach	5,901	Impressions	5,917
Interactions	43	Link clicks	--

**Reach**  
Followers vs. non-followers

595 Followers | 5295 Non-followers

**Interactions**

Reactions	35
Comments	6
Shares	2
Saves	0

👍 35 | 🍷 1 | 😂 0 | 🙄 0 | 🤔 0 | 😡 0



Reach	971	Impressions	981
Interactions	7	Link clicks	--

**Reach**  
Followers vs. non-followers

461 Non-followers | 500 Followers

**Interactions**

Reactions	7
Comments	0
Shares	0
Saves	0

👍 7 | 🍷 1 | 😂 0 | 🙄 0 | 🤔 0 | 😡 0



# MAKERY DEPARTMENT REPORT

## DECEMBER 2024

	This Month	Last Month	Last Year
<b>People Counter</b>	<b>1,998</b>	1947	2,184
<b>Equipment Reservations</b>	<b>457</b>	302	583
<b>3D Prints</b>	<b>68</b>	61	68



Makery - Year to date compared to last year  
 1 Locations Grouped  
 Period 1: 1/1/2023 to 12/31/2023  
 Period 2: 1/1/2024 to 12/31/2024

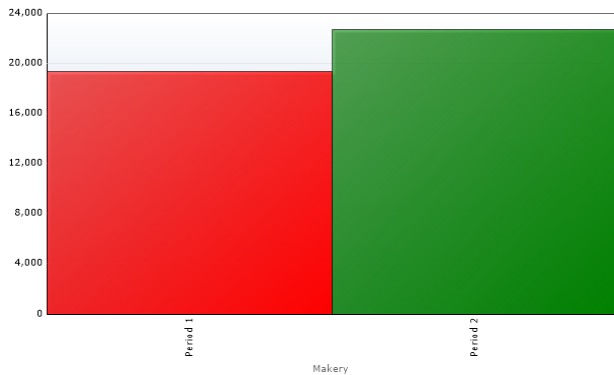

### Year-End Stats

Year over year, the number of Makery visitors increased by 18% from 2023 to 2024. This is still a sizable jump after the remarkable 41% growth between 2022 and 2023.

### Another Busy Holiday Season

December was once again one of the busiest months of the year in the Makery. Lots of families come in for activities while the kids are off school and many more come in to make gifts.

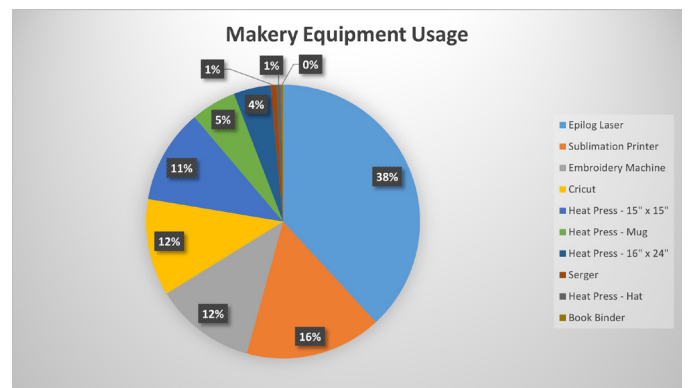
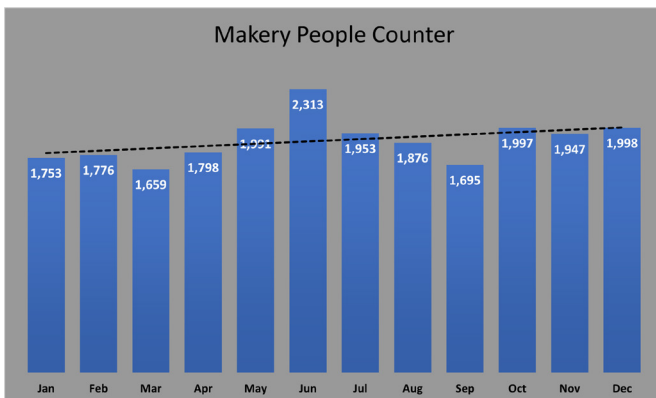

### Monthly Stats

Month over month, the number of Makery visitors trended upwards. As usual, the peaks occurred in the Summer and in December. The December peak was relatively lower this year than last year.

### Equipment Reservation Stats

Equipment usage continued trends of prior years. The laser was the most popular piece of equipment. Much of the laser's usage came in December. The laser was booked solid for two full weeks leading up to Christmas.



# PROGRAM STATISTICS

December 2024

Adult Programs	Primary Event Type	Attendance	Sessions
Adult Book Discussion: Trading Titles	Book Discussion	10	2
American Mah Jongg: Open Play	Games	32	3
Analog to Digital Conversion	Technology	10	1
Beaded Snowflakes	Create	27	1
Beginning Cross-Stitch	Create	12	2
Behind the Scenes: National Lampoon's Christmas Vacation	Enrich	26	1
Bingo	Games	10	1
Board Game Night	Enrich	3	1
Bridge and Pinochle	Games	67	4
Button Trees	Create	20	1
Canasta: Open Play	Games	34	4
Chair Yoga	Gather	55	2
Ciao Italia	Enrich	8	1
Coloring for Mindfulness	Create	9	1
Creative Cardmaking: Winter Holidays	Create	24	2
Culture Club: Chicago in Winter	Enrich	21	1
ELSA Alumni Holiday Party		10	1
Friday Features	Movies	26	4
GreenMan Theatre Presents Seasonal Stories	Enrich	65	1
Holiday Traditions from Radio's Golden Age	Enrich	16	1
Honeycomb Ornament	Create	15	1
Illinois Libraries Present: Little Women: The Musical	Arts and Culture	45	1
Illinois Libraries Present: The Magic of Raina Telgemeier	Books and Authors	26	1
In Stitches Needleworkers	Create	8	1
It's Christmastime in the City: Chicago and Its Yule Contributions and Traditions	Enrich	42	1
Library Insiders: Library Tour	Library Insiders	4	1
Needlefelted Ornaments	Create	11	1
Next Chapter Book Club	Library Insiders	16	1
Resume Review	Career & Job Hunting	1	1
Scrabble	Games	16	2
Start the New Year With Meditation	Enrich	12	1
Staying Mentally Fit	Gather	10	1
The Ultimate Presentation for Cubs Nation	Enrich	12	1
Upcycled Gift Tags	Create	17	1
Winter Stitch-Along	Create	699	4
<b>TOTALS</b>		<b>1,419</b>	<b>54</b>
Teen Programs	Primary Event Type	Attendance	Sessions
Teen Advisory Group	Teen Program	12	1
Teen Crafternoon: Perler Bead Magnetic Frames	Create	8	1
<b>TOTALS</b>		<b>20</b>	<b>2</b>
Middle School Programs	Primary Event Type	Attendance	Sessions
Celebrate and Play PlayStation	Games	8	1
Homeschool Explorers	Homeschool	12	1

Middle School Influencers	Middle School Influencers	2	1
Outreach Middle School AT Bryan (6th Grade)	Outreach	216	4
Outreach Middle School AT Bryan (7th Grade)	Outreach	224	4
Outreach Middle School AT Churchville (6th Grade)	Outreach	138	6
Outreach Middle School AT Sandburg (6th Grade)	Outreach	204	4
Outreach Middle School AT Sandburg (7th Grade)	Outreach	200	4
<b>TOTALS</b>		<b>1,004</b>	<b>25</b>
<b>Kids' Library Programs</b>			
	<b>Primary Event Type</b>	<b>Attendance</b>	<b>Sessions</b>
After School Gaming	Games	6	1
Art Museum Storytime	Storytime	49	2
Baby Play Date	Family	2	1
C.I.T.Y. of Support Playgroup	Inclusive	12	1
Craft Table-Passive		1,425	5
Family Sensory Hour	Family	18	1
Lego Engineering Jr.	STEAM	19	2
Little Wiggles	Storytime	408	7
Mother Goose & Me	Storytime	78	5
Nanny Nikki Winter Musical Show	Music	78	1
New Year's Eve Dance Party	Family	70	1
Outreach Elementary Fischer (3rd Grade)	Outreach	110	2
OUTREACH Preschool AT Pythagoras	Outreach	15	1
OUTREACH Preschool AT Tree Town	Outreach	41	2
Polar Express Storytime	Storytime	45	1
Polar Express T-Trak Model Railroad		575	2
Romp & Rhyme	Storytime	132	4
Santa at Wilder Mansion (OUTREACH)	Outreach	380	1
Saturday STEM	STEAM	21	1
Scout Visit Marble Madness	Outreach	11	1
Spanish/English Storytime	Storytime	12	1
Sweet Street Storytime	Storytime	85	3
Trolley Storytime		30	1
Winter Break Movies	Movies	48	2
<b>TOTALS</b>		<b>3,670</b>	<b>49</b>
<b>Passive Programs</b>			
	<b>Primary Event Type</b>	<b>Attendance</b>	<b>Sessions</b>
<b>Adult Passive Programs:</b>			
Crossword Interactive Display		288	1
Puzzles		18	2
Recording of Culture Club: Chicago in Winter (Online)		61	1
Recording of GreenMan Theatre Seasonal Stories (Online)		61	1
Recording of It's Christmastime in the City (Online)		104	1
Winter Reading		29	1
<b>Teen Passive Programs:</b>			
Best Music Artist		86	1
<b>Middle School Passive Programs:</b>			
Middle School Hangout Passive & Pop-Up		27	2
<b>Kids' Passive Programs:</b>			
Winter Reading for Grades 4-5 (Online)		56	1
Winter Reading for Grades 2-3 (Online)		49	1
Winter Reading for Grades K-1 (Online)		56	1



	Attendance	Sessions
<b>Adult Program Grand Total</b>	<b>1980</b>	<b>61</b>
Total Passive Program Statistics	561	7
Total Program Statistics	1,419	54
<b>Teen Program Grand Total</b>	<b>106</b>	<b>3</b>
Total Passive Program Statistics	86	1
Total Program Statistics	20	2
<b>Middle School Program Grand Total</b>	<b>1,031</b>	<b>27</b>
Total Passive Program Statistics	27	2
Total Program Statistics	1,004	25
<b>Kids' Program Grand Total</b>	<b>3,831</b>	<b>52</b>
Total Passive Program Statistics	161	3
Total Program Statistics	3,670	49
<b>Passive Program Total</b>	<b>835</b>	<b>13</b>
<b>Total Attendance</b>	<b>6,948</b>	
<b>Total Programs</b>		<b>143</b>

# STATISTICAL REPORT

## December 2024

### Circulation

**Total Circulation**  
**81,719** ↓ -5%  
 85,970 last year  
**Card Holders**  
 25,762

**Library Card Usage**  
**9,232** ↑ 2%  
 9,042 last year

**Library Cards Issued**  
**Elmhurst** **149** ↓ -3%  
 (Issued) 154 last year  
**Reciprocal Borrower** **41** ↓ -16%  
 (Registered) 49 last year

**Interlibrary Loan**  
**Borrowed** **1,066** ↓ -7%  
 1,149 last year  
**Lent** **492** ↑ 0%  
 491 last year

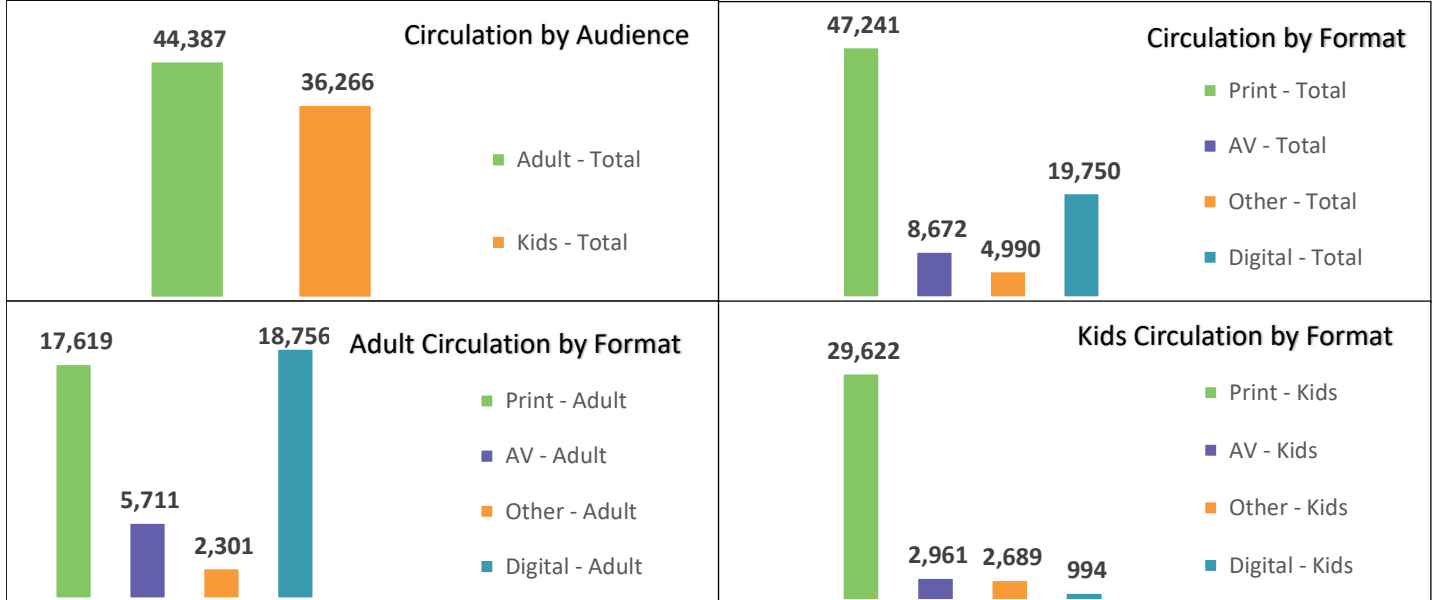

### Technology Usage

#### Public Computer Use

**14,924** ↓ -9%  
 16,419 last year

#### Website Visits

**34,614** ↓ -79%  
 165,265 last year

#### Self Checkout

(% of checkouts)

**53%** ↑ 2%  
 52% last year

#### WiFi Sessions

**21,049** ↓ -14%  
 24,552 last year

### Reference Queries

#### Reference Questions Total

**3,617** ↓ -21%  
 4,556 last year

#### Reference Questions

**Adult**  
**2,332** ↓ -30%  
 3,327 last year

**Kids**  
**1,285** ↑ 5%  
 1,229 last year

### Meeting Room Use

#### Library Programs

**143** ↓ -3%  
 148 last year

#### Public Meetings

**71** ↑ 58%  
 45 last year

#### Group Study Rooms

**1,824** ↑ 5%  
 1,736 last year

### Programs

#### Program Attendance

**6,948** ↓ -7%  
 7,465 last year

#### Library Programs

**143** ↓ -3%  
 148 last year

#### Program Attendance By Audience

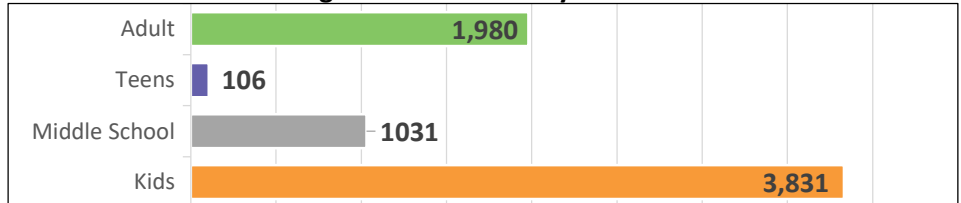

### Library Visits

#### Total Visits

**36,652** ↑ 2%  
 35,996 last year

#### In House Visits

**Makery** **1,998** ↑ 102%  
 991 last year

**Walk-In**  
**34,994** ↑ 2%  
 34,298 last year

**Drive-Up Visits**  
**1,658** ↓ -2%  
 1,698 last year

**Creative Studio** **100** ↑ 3%  
 97 last year



### Monthly Comparison

#### Total Circulation

81,719 -5%  
85,970 last year

#### Adult Circulation

44,387 -6%  
47,193 last year

#### Kids Circulation

36,266 -4%  
37,629 last year

#### ILL Borrowed from Other Libraries

1,066 -7%  
1,149 last year

#### Digital Material Circulation

19,750 -5%  
20,862 last year

#### Databases

100,635 1145%  
8,082 last year

#### Reference Questions Total

3,617 -21%  
4,556 last year

#### One on One Tutorials

29 -12%  
33 last year

#### Number of Programs

143 -3%  
148 last year

#### Program Attendance

6,948 -7%  
7,465 last year

#### In-Person Visitors

34,994 2%  
34,298 last year

#### Drive-Up Visitors

1,658 -2%  
1,698 last year

### Year To Date Comparison

#### Total Circulation

1,088,546 -2%  
1,116,097 last year

#### Adult Circulation

577,593 -2%  
591,534 last year

#### Kids Circulation

495,597 -3%  
509,412 last year

#### ILL Borrowed from Other Libraries

15,357 1%  
15,152 last year

#### Digital Material Circulation

254,936 5%  
243,157 last year

#### Databases

435,733 137%  
183,690 last year

#### Reference Questions Total

52,677 -2%  
53,604 last year

#### One on One Tutorials

424 -27%  
584 last year

#### Number of Programs

2,071 -6%  
2,213 last year

#### Program Attendance

83,959 13%  
74,573 last year

#### In-Person Visitors

469,524 7%  
438,413 last year

#### Drive-Up Visitors

21,612 -3%  
22,190 last year

## Collection Totals

### Books and Magazines

162,345

### Library of Extraordinary Things and Electronics

6,100

### Audio Visual

27,176

### Digital

177,396

## Notable Happenings in Circulation

- Three *Cards for Kids* library card were issued in December.
- There are 39 active *Cards for Kids* library cards.
- Four Non resident cards were purchased this month for a total of \$618.32.
- There are 131 active Non resident library cards (patrons living in unincorporated Elmhurst).
- We filled 4,347 holds this month.